

FLEX

OPERATOR'S MANUAL

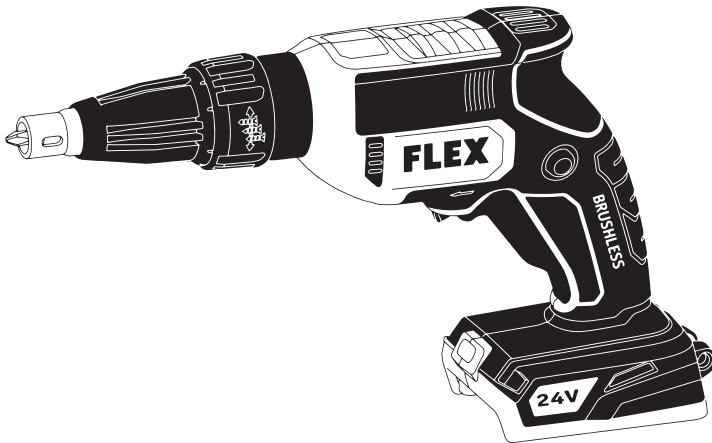

Model: FXA1611

24V BRUSHLESS DRYWALL SCREWDRIVER

⚠ WARNING: To reduce the risk of injury, the user must read and understand the Owner's Manual before using this product. Save these instructions for future reference.







Please contact FLEX customer service in Australia 1300 000 346 or
New Zealand 0508 000 346 any time you have questions or warranty claims.

SAFETY SYMBOLS

The purpose of safety symbols is to attract your attention to possible dangers. The safety symbols and the explanations with them deserve your careful attention and understanding. The symbol warnings do not, by themselves, eliminate any danger. The instructions and warnings they give are no substitutes for proper accident prevention measures.

 **WARNING** Be sure to read and understand all safety instructions in this Owner's Manual, including all safety alert symbols such as “**DANGER**,” “**WARNING**,” and “**CAUTION**” before using this tool. Failure to follow all instructions listed below may result in electric shock, fire, and/or serious personal injury.

The definitions below describe the level of severity for each signal word. Please read the manual and pay attention to these symbols.	
	This is the safety alert symbol. It is used to alert you to potential personal injury hazards. Obey all safety messages that follow this symbol to avoid possible injury or death.
	DANGER indicates a hazardous situation which, if not avoided, will result in death or serious injury.
	WARNING indicates a hazardous situation which, if not avoided, could result in death or serious injury.
	CAUTION, used with the safety alert symbol, indicates a hazardous situation which, if not avoided, will result in minor or moderate injury.

GENERAL POWER TOOL SAFETY WARNINGS



WARNING Read all safety warnings, instructions, illustrations and specifications provided with this power tool. Failure to follow all instructions listed below may result in electric shock, fire and/or serious injury.

SAVE ALL WARNINGS AND INSTRUCTIONS FOR FUTURE REFERENCE.

The term “power tool” in the warnings refers to your mains-operated (corded) power tool or battery-operated (cordless) power tool.

Work area safety

Keep work area clean and well lit. Cluttered or dark areas invite accidents.

Do not operate power tools in explosive atmospheres, such as in the presence of flammable liquids, gases or dust. Power tools create sparks which may ignite the dust or fumes.

Keep children and bystanders away while operating a power tool. Distractions can cause you to lose control.

Electrical safety

Power tool plugs must match the outlet. Never modify the plug in any way. Do not use any adapter plugs with earthed (grounded) power tools. Unmodified plugs and matching outlets will reduce risk of electric shock.

Avoid body contact with earthed or grounded surfaces, such as pipes, radiators, ranges and refrigerators. There is an increased risk of electric shock if your body is earthed or grounded.

Do not expose power tools to rain or wet conditions. Water entering a power tool will increase the risk of electric shock.

Do not abuse the cord. Never use the cord for carrying, pulling or unplugging the power tool. Keep cord away from heat, oil, sharp edges or moving parts. Damaged or entangled cords increase the risk of electric shock.

When operating a power tool outdoors, use an extension cord suitable for outdoor use. Use of a cord suitable for outdoor use reduces the risk of electric shock.

If operating a power tool in a damp location is unavoidable, use a residual current device (RCD) protected supply. Use of an RCD reduces the risk of electric shock.

Personal safety

Stay alert, watch what you are doing and use common sense when operating a power tool. Do not use a power tool while you are tired or under the influence of drugs, alcohol or medication. A moment of inattention while operating power tools may result in serious personal injury.

Use personal protective equipment. Always wear eye protection. Protective equipment such as a dust mask, non-skid safety shoes, hard hat or hearing protection used for appropriate conditions will reduce personal injuries.

Prevent unintentional starting. Ensure the switch is in the off-position before connecting to power source and/or battery pack, picking up or carrying the tool. Carrying power tools with your finger on the switch or energizing power tools that have the switch on invites accidents.

Remove any adjusting key or wrench before turning the power tool on. A wrench or a key left attached to a rotating part of the power tool may result in personal injury.

Do not overreach. Keep proper footing and balance at all times. This enables better control of the power tool in unexpected situations.

Dress properly. Do not wear loose clothing or jewelry. Keep your hair and clothing away from moving parts. Loose clothes, jewelry or long hair can be caught in moving parts.

If devices are provided for the connection of dust extraction and collection facilities, ensure these are connected and properly used. Use of dust collection can reduce dust-related hazards.

Do not let familiarity gained from frequent use of tools allow you to become complacent and ignore tool safety principles. A careless action can cause severe injury within a fraction of a second.

Power tool use and care

Do not force the power tool. Use the correct power tool for your application. The correct power tool will do the job better and safer at the rate for which it was designed.

Do not use the power tool if the switch does not turn it on and off. Any power tool that cannot be controlled with the switch is dangerous and must be repaired.

Disconnect the plug from the power source and/or remove the battery pack, if detachable, from the power tool before making any adjustments, changing accessories, or storing power tools. Such preventive safety measures reduce the risk of starting the power tool accidentally.

Store idle power tools out of the reach of children and do not allow persons unfamiliar with the power tool or these instructions to operate the power tool. Power tools are dangerous in the hands of untrained users.

Maintain power tools and accessories. Check for misalignment or binding of moving parts, breakage of parts and any other condition that may affect the power tool's operation. If damaged, have the power tool repaired before use. Many accidents are caused by poorly maintained power tools.

Keep cutting tools sharp and clean. Properly maintained cutting tools with sharp cutting edges are less likely to bind and are easier to control.

Use the power tool, accessories and tool bits etc. in accordance with these instructions, taking into account the working conditions and the work to be performed.

Use of the power tool for operations different from those intended could result in a hazardous situation.

Keep handles and grasping surfaces dry, clean and free from oil and grease. Slippery handles and grasping surfaces do not allow for safe handling and control of the tool in unexpected situations.

Battery tool use and care

Recharge only with the charger specified by the manufacturer. A charger that is suitable for one type of battery pack may create a risk of fire when used with another battery pack.

Use power tools only with specifically designated battery packs. Use of any other battery packs may create a risk of injury and fire.

When battery pack is not in use, keep it away from other metal objects, like paper clips, coins, keys, nails, screws or other small metal objects, that can make a connection from one terminal to another. Shorting the battery terminals together may cause burns or a fire.

Under abusive conditions, liquid may be ejected from the battery; avoid contact. If contact accidentally occurs, flush with water. If liquid contacts eyes, additionally seek medical help. Liquid ejected from the battery may cause irritation or burns.

Do not use a battery pack or tool that is damaged or modified. Damaged or modified batteries may exhibit unpredictable behavior resulting in fire, explosion or risk of injury.

Do not expose a battery pack or tool to fire or excessive temperature. Exposure to fire or temperature above 130°C may cause explosion.

Follow all charging instructions and do not charge the battery pack or tool outside the temperature range specified in the instructions. Charging improperly or at temperatures outside the specified range may damage the battery and increase the risk of fire.

Service

Have your power tool serviced by a qualified repair person using only identical replacement parts. This will ensure that the safety of the power tool is maintained.

Never service damaged battery packs.

Service of battery packs should only be performed by the manufacturer or authorized service providers.

SAFETY RULES SPECIFIC FOR DRYWALL SCREWDRIVERS

Hold power tool by insulated gripping surfaces, when performing an operation where the fastener may contact hidden wiring. Fasteners contacting a “live” wire may make exposed metal parts of the power tool “live” and could give the operator an electric shock.

Hold the electric power tool securely. When tightening and loosening screws, high reaction torques may occur briefly.

Secure the workpiece. A workpiece is held more securely in a clamping device or vice than by hand.









Wait until the electric power tool has come to a standstill before putting it down. The insertion tool may jam and cause you to lose control of the electric power tool.



Wear suitable clothing. Do not wear any loose clothing or jewelry. Keep hair, clothing and gloves away from moving parts. Loose clothing, jewelry or long hair may become caught in moving parts.

Do not point the electric power tool at yourself or at other people nearby.

SYMBOLS

IMPORTANT: Some of the following symbols may be used on your tool. Please study them and learn their meaning. Proper interpretation of these symbols will allow you to operate the tool better and safer.

Symbol	Name	Designation/Explanation
V	Volts	Voltage
A	Amperes	Current
Hz	Hertz	Frequency (cycles per second)
W	Watt	Power
kg	Kilograms	Weight
min	Minutes	Time
s	Seconds	Time
Wh	Watt-hours	Battery capacity
Ah	Ampere-hours	Battery capacity
ø	Diameter	Size of drill bits, grinding wheels, etc.
n_0	No load speed	Rotational speed, at no load
n	Rated speed	Maximum attainable speed
.../min	Revolutions or reciprocations per minute (rpm)	Revolutions, strokes, surface speed, orbits, etc. per minute
O	Off position	Zero speed, zero torque...
1,2,3,... I,II,III,	Selector settings	Speed, torque, or position settings. Higher number means greater speed
0 	Infinitely variable selector with off	Speed is increasing from 0 setting
	Arrow	Action in the direction of arrow
	Alternating current (AC)	Type or a characteristic of current
	Direct current (DC)	Type or a characteristic of current
	Alternating or direct current (AC / DC)	Type or a characteristic of current
	Class II tool	Designates Double Insulated Construction tools.
	Read the instructions	Alerts user to read manual
	Wear eye protection symbol	Alerts user to wear eye protection

Symbol	Name	Designation/Explanation
	Disposal information for the old machine	Do not throw electric power tools into the household waste!
	Regulatory compliance mark	This product complies with applicable Australian standards.

FUNCTIONAL DESCRIPTIONS AND SPECIFICATIONS

Drywall Screwdriver

Fig. 1

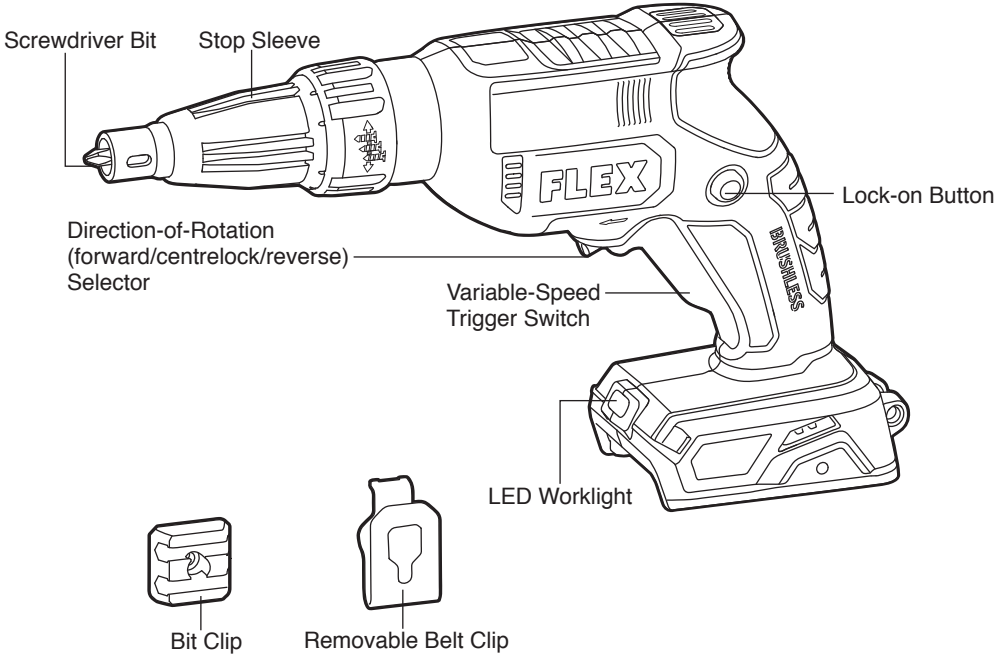

Model no.	FXA1611
Rated voltage	24 V d.c.
No-load speed (RPM)	0-4500 /min
Chuck size	6.35 mm Hex
Max. torque (hard/soft)	3.2/0.7 Nm
Recommended operating temperature	-20 – 40°C
Recommended storage temperature	< 50°C

Intended Use

This tool is intended for attaching drywall, chipboard, or fiberboard onto wood or sheet metal with drywall screws.

ASSEMBLY

⚠ WARNING Detach the battery pack from the tool before making any assembly, adjustments or changing accessories. Such preventive safety measures reduce the risk of starting the tool accidentally.

TO ATTACH/DETACH BATTERY PACK (FIG. 2)

Lock the variable-speed trigger switch “OFF” on the tool by placing the direction-of-rotation (forward/centre-lock/reverse) selector in the centre position before attaching or detaching the battery pack.

To attach the battery pack:

Align the raised rib on the battery pack with the grooves in the tool, and then slide the battery pack onto the tool.

NOTICE: When placing the battery pack onto the tool, be sure that the raised rib on the battery pack aligns with the groove inside the tool and that the latches snap into place properly. Improper attachment of the battery pack can cause damage to internal components.

Fig. 2

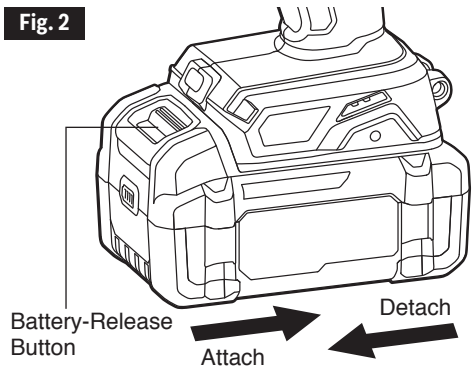

To detach the battery pack:

Depress the battery-release button located on the front of the battery pack, to release the battery pack. Pull the battery pack out and remove it from the tool.

REMOVABLE BELT CLIP AND BIT CLIP (FIG. 3 & 4)

Your tool is equipped with a removable belt clip that can be positioned on the left or right side of the tool for convenient transport.

Install the belt clip onto the tool:

- Remove the battery pack from the tool.
- Align the rib of the belt clip with the threaded hole on the base of the tool.
- Insert the screw and securely tighten the screw with a screwdriver.

Remove the belt clip from the tool:

- Remove the battery pack from the tool.
- Use a screwdriver to loosen the screw that attaches the belt clip to the tool.
- Remove the screw and the belt clip.

NOTICE: Your tool is also equipped with a removable bit clip that can be positioned on the left or right side of the tool for storing bits. The installation method is the same as for the belt clip (Fig. 4)

Fig. 3

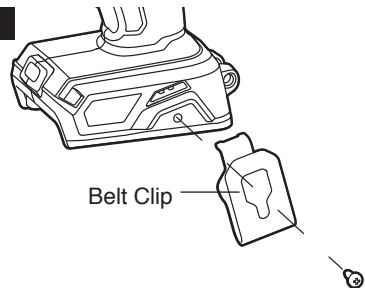
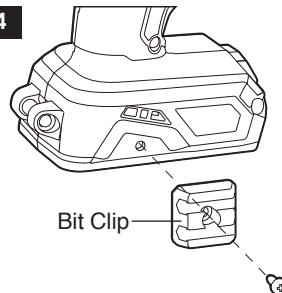

Fig. 4



CHANGING BIT HOLDER

⚠ WARNING Lock the variable-speed trigger switch “OFF” by placing the direction-of-rotation selector in the centre position.

- Pull the stop sleeve out and remove it from the tool (Fig. 5).
- Push the clutch toward the rear of the tool and pull the bit holder out from the gearcase (Fig. 6).
- Push the clutch toward the rear of the tool and push the bit holder into the gearcase.
- Release the clutch and ensure that the bit-holder shank is locked in the gearcase securely.
- Attach the stop sleeve to the tool.

Fig. 5

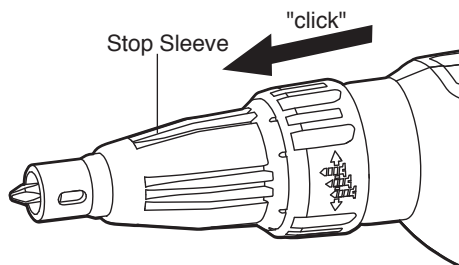
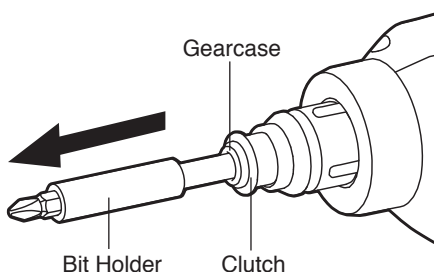

Fig. 6



CHANGING SCREWDRIVER BIT

⚠ WARNING Lock the variable-speed trigger switch “OFF” by placing the direction-of-rotation selector in the centre position.

- Pull the stop sleeve out and remove it from the tool (Fig. 5).
- Remove the worn screwdriver bit with pliers and install the new bit (Fig. 7).
- Attach the stop sleeve to the tool.

⚠ WARNING Use protective gloves when removing the bit from the tool, or first allow the bit to cool down. The bit may be hot after prolonged use.

Fig. 7

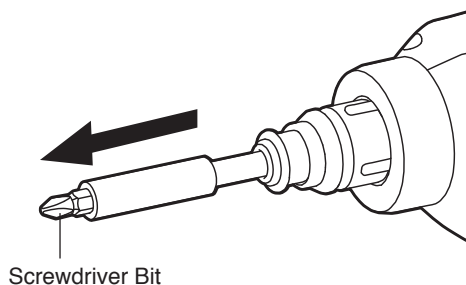

ADJUSTMENTS

DIRECTION-OF-ROTATION (FORWARD/CENTRE-LOCK/REVERSE) SELECTOR (FIG. 8)

⚠ WARNING After tool use, lock the direction-of-rotation selector in the “OFF” position (centre-lock) to help prevent accidental starts and possible injury.

Your tool is equipped with a direction-of-rotation selector, located above the variable-speed trigger switch. This selector is used to change the direction of rotation of the bit and to lock the variable-speed trigger in the “OFF” (centre-lock) position.

- Position the direction-of-rotation selector to the far left of the tool for reverse rotation (loosening screws).
- Position the direction-of-rotation selector to the far right of the tool for forward rotation (tightening screws).
- Position the direction-of-rotation selector in the “OFF” (centre-lock) position to help reduce the possibility of accidental starting when not in use.

NOTICE: To prevent gear damage, always allow the screwdriver to come to a complete stop before changing the direction of rotation.

Fig. 8

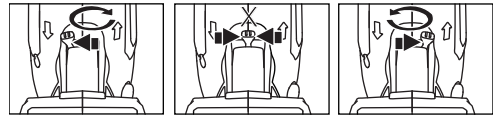
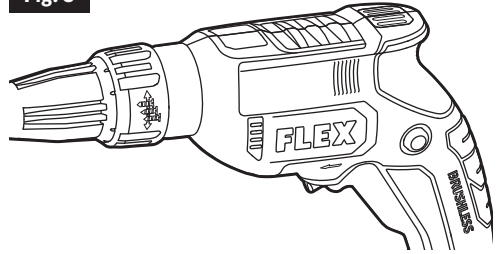

NOTICE: The screwdriver will not run unless the direction-of-rotation selector is engaged fully to the left or to the right.

⚠ WARNING Battery tools are always in operating condition.

Therefore, the direction-of-rotation (forward/centre-lock/reverse) selector should always be locked in the centre position when the tool is not in use or when carrying it at your side.

CHANGING SCREW-IN DEPTH (FIG. 9)

⚠ WARNING Lock the variable-speed trigger switch “OFF” by placing the direction-of-rotation selector in the centre position.

Change screw-in depth by turning the stop sleeve for the screw-depth stop.

- Turn the stop sleeve clockwise: Screw-in depth increases.
- Turn the stop sleeve counterclockwise: Screw-in depth decreases.

One notch (45°) on the stop sleeve corresponds to a 0.008" (0.2mm) change in the screw-in depth of.

One complete rotation (360°) of the stop sleeve corresponds to a change in the screw-in depth of 1/16" (1.6mm).

Fig. 9

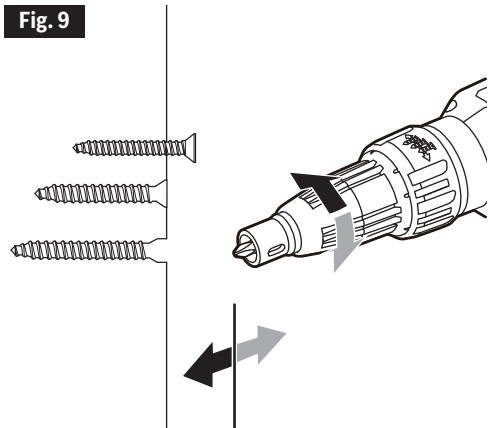

NOTICE: Start with a fairly shallow screw-in depth to prevent damaging the workpieces that are to be screwed in place.

OPERATION INSTRUCTIONS

⚠ WARNING Battery tools are always in operating condition. Be careful when the tool is not in use or when carrying it at your side.

VARIABLE-SPEED TRIGGER SWITCH (FIG. 10)

Your tool is equipped with a variable-speed trigger switch. The tool can be turned “ON” or “OFF” by depressing or releasing the variable-speed trigger switch. The variable-speed trigger switch delivers higher speed with increased trigger pressure and lower speed with decreased trigger pressure.

Fig. 10

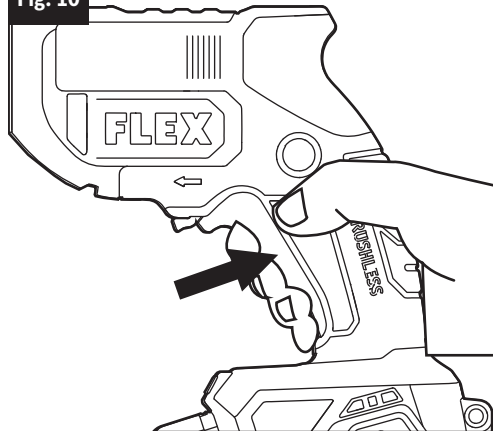

LOCK-ON BUTTON

Your tool is equipped with a lock-on button, lock the switch in the ON position for continuous operation.

Switch on:

Depress and hold down the trigger switch, then press the lock-on button to lock the trigger switch. The tool will continue to run (Fig. 11).

Switch off:

Squeeze and release the variable-speed trigger switch once.

Before using the tool each time, be sure that the lock-on button release mechanism is working properly.

Fig. 11

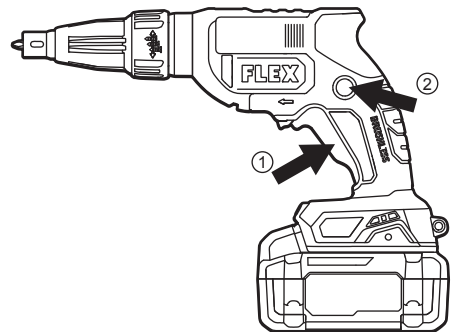

⚠ WARNING Be sure to release the locking mechanism before removing the battery from the tool. Failure to do so will cause the tool to start immediately the next time the battery is installed. Damage or injury could result.

LED LIGHT (FIG. 12)

Your tool is equipped with an LED light, located on the base of the tool. This provides additional light on the surface of the work piece for operation in lower-light areas.

The LED light will automatically turn on with a slight squeeze on the variable-speed trigger switch before the tool starts running and will turn off approximately 10 seconds after the variable-speed trigger switch is released.

The LED light will rapidly flash when the tool and/or battery pack becomes overloaded or too hot, and the internal sensors will turn the tool off. Rest the tool for a while or place the tool and battery pack separately under air flow to cool them.

The LED light will flash more slowly to indicate that the battery is at low-battery capacity. Recharge the battery pack.

If the LED fails to light up when you switch on the tool, or it turns off suddenly during your operation, it may be caused by the internal communication error. Please contact customer service or an authorized service centre for assistance.

⚠ WARNING To reduce the risk of fire, personal injury, and product damage due to a short circuit, never immerse your tool, battery pack or charger in fluid or allow a fluid to flow inside them. Corrosive or conductive fluids, such as seawater, certain industrial chemicals, and bleach or bleach-containing products, etc. can cause a short circuit.

⚠ WARNING If any parts are damaged or missing, do not operate this product until the parts are replaced. Use of this product with damaged or missing parts could result in serious personal injury.

Fig. 12

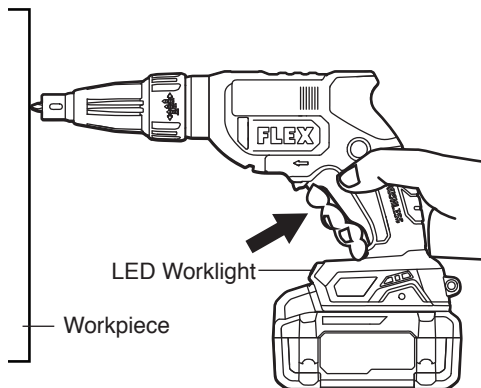

⚠ WARNING Do not attempt to modify this tool or create accessories not recommended for use with this tool. Any such alteration or modification is misuse and could result in a hazardous condition leading to possible serious injury.

⚠ WARNING To prevent accidental starting that could cause serious personal injury, always remove the battery pack from the tool when assembling parts, making adjustments, or cleaning the tool.

This drywall screwdriver must be used only with the FLEX 24V series battery packs and chargers.

NOTICE: Please refer to the battery pack and charger manuals for detailed operating information.

NOTICE: Do not grip the rotating screwdriver head during operation (Fig. 13).

Fig. 13

Screwing in screws:

- a. Insert an appropriate screwdriver bit.
- b. Set the screw-in depth.
- c. Set the direction of rotation to forward rotation.
- d. Grip the tool with one hand on the handle and assume a working position.
- e. Place a screw on the screwdriver bit. The screw is held by magnetic force.
- f. Press the screw tip against the workpiece to be screwed in place until the stop sleeve is positioned on the workpiece. Hold the tool at right angles to the surface of the workpiece.
- g. Turn on the tool. The screw is screwed into the workpiece until the set screw-in depth is reached.

Check the screw-in depth, change if required.

NOTICE: When the preset screw-in depth is reached, the drive is disengaged and the screwdriver bit stops turning.

- h. When you have finished driving screws, turn off the tool.
- i. At the end of work, move the direction-of-rotation selector to the centre-lock position.

Loosening screws:

- a. Insert an appropriate screwdriver bit.
- b. Set direction of rotation to reverse rotation.
- c. Grip the tool with one hand on the handle and assume a working position.
- d. Place the screwdriver bit on the screw to be loosened.
- e. Turn on the tool by pressing the variable-speed trigger switch to loosen the screw.
- f. After loosening the screw, release the trigger switch.
- g. At the end of work: move the direction-of-rotation selector to the centre-lock position.

NOTICE: The screwdriver bit will not turn until pressure is applied to the screw. Push to engage.

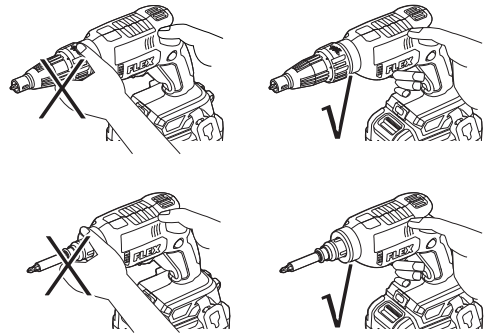

MAINTENANCE

⚠ WARNING To avoid serious personal injury, always remove the battery pack from the tool when cleaning or performing any maintenance.

SERVICE

⚠ WARNING Preventive maintenance performed by unauthorized personnel may result in misplacing of internal wires and components which could cause a serious hazard. We recommend that all tool service be performed by a FLEX Factory Service Centre or Authorized FLEX Service Station.

GENERAL MAINTENANCE

⚠ WARNING When servicing, use only identical replacement parts. Use of any other parts could create a hazard or cause product damage. Periodically inspect the entire product for damaged, missing, or loose parts such as screws, nuts, bolts, caps, etc. Tighten securely all fasteners and caps and do not operate this product until all missing or

damaged parts are replaced. Please contact customer service or an authorized service centre for assistance.

CLEANING

⚠ WARNING The tool may be cleaned most effectively with compressed dry air. Always wear safety goggles when cleaning tools with compressed air. Ventilation openings and switch levers must be kept clean and free of foreign matter. Do not attempt to clean by inserting pointed objects through openings.

⚠ WARNING Certain cleaning agents and solvents damage plastic parts. Some of these are: gasoline, carbon tetrachloride, chlorinated cleaning solvents, ammonia and household detergents that contain ammonia.

STORAGE

Store the tool indoors in a place that is inaccessible to children. Keep it away from corrosive agents.

ACCESSORIES

⚠ WARNING The use of any other accessories not specified in this manual may create a hazard.

Belt Clip

Bit Holder

Magnetic Bit Holder

Long PR2 Bit

Short PH2 Bit

WARRANTY STATEMENT

Chervon Australia Pty Ltd (ABN 36 165 077 501) of Unit 14,5 Kelletts Road, Rowville, Victoria, 3178, and Chervon New Zealand Subsidiary Ltd (NZBN 9429049277616) (**Chervon**) provides the following warranty (**Warranty**) to original domestic purchasers in Australia and New Zealand as applicable (**Customers**) of its FLEX24V Tools, FLEX24V Batteries and Chargers and FLEX STACK PACK Storage System (collectively **Products**).

The benefits of this Warranty are in addition to any rights and remedies imposed by Australian State and Federal or New Zealand legislation that cannot be excluded. Nothing in this Warranty is to be interpreted as excluding, restricting or modifying any legislation relevant to the supply of goods and services in Australia or New Zealand, as applicable, which cannot be excluded, restricted or modified.

In Australia, if the claimant is a “consumer” under the Australian Consumer Law, Chervon confirms the following:

Our goods come with guarantees that cannot be excluded under the Australian Consumer Law. You are entitled to a replacement or refund for a major failure and compensation for any other reasonably foreseeable loss or damage. You are also entitled to have the goods repaired or replaced if the goods fail to be of acceptable quality and the failure does not amount to a major failure.

WARRANTY

Chervon warrants that, subject to the terms of this Warranty and the exclusions and limitations contained herein, the Products will be free from defects in materials and workmanship for the following period, as applicable, calculated from the date of purchase of the Product (**Warranty Period**):

- If the Customer registers its purchase of the Product online at www.flex-tools.com.au or by calling 1300 000 346 in Australia or www.flex-tools.co.nz or by calling 0508 000 346 in New Zealand within 30 days of the date of its purchase (**Registration**), the Warranty Period for the following Products is as follows:
 - FLEX 24V Tools: 5 years;
 - FLEX 24V Batteries and Chargers: 5 years;
 - FLEX Stack Pack™ Storage System: 1 year;
 - FLEX Accessories & Consumables: 90Days
- If the Customer fails to complete Registration as outlined above, the Warranty Period for the following Products is as follows:
 - FLEX 24V Tools: 3 years;
 - FLEX 24V Batteries and Chargers: 3 years;
 - FLEX Stack Pack™ Storage System: 1 year;
 - FLEX Accessories & Consumables: 90 Days

For further clarification and avoidance of doubt please refer to the FLEX product warranty table included below.

If, before the end of the Warranty Period, a defect appears in the manufacture or assembly of a Product, and Chervon finds the Product to be defective in materials or workmanship, it will, in its sole discretion, either:

- replace or repair the Product or the defective part of the Product free of charge; or
- cause the Product or the defective part of the Product to be replaced or repaired free of charge.

Chervon reserves the right to replace a defective Product or part of a Product with parts and components of similar quality, grade and composition where an identical part or component is not available. Where the product is repaired, Chervon may use refurbished parts.

WARRANTY CLAIMS

1. If a defect covered by Warranty appears, you must first contact Chervon:
 - a) by telephone on 1300 000 346 (AU); or 0508 000 346 (NZ); or
 - b) by email at support@flex-tools.com.au
2. Any Warranty claim must be accompanied by:
 - a) proof of purchase;
 - b) full details of the alleged defect;
 - c) photo evidence of the alleged defect; and
 - d) any other relevant documents.
3. You must allow Chervon or its authorised agent to inspect and test the Product. If that inspection and test finds no defect in the Product, you must pay Chervon's usual service and testing costs.
4. Unless otherwise agreed in writing by Chervon, you must pay the cost of transporting the Product to and from Chervon or Chervon's authorised agent and any related insurance cost. Any handling and transportation costs (and other expenses incurred in claiming this warranty) are not covered by this warranty and will not be borne by Chervon.
5. The replacement product or part, or repaired product will be made available for your collection at an address nominated by Chervon.
6. Customers are responsible for the care and cleaning of their product prior to sending it to back to Chervon or its nominated authorised repair agents. Any product being sent for repair must be cleaned. It is an Occupational/Work Health and Safety risk for our staff or authorised repairers to inspect, repair or service a product that has come into contact with a hazardous substance.
7. If Chervon or its authorised repair agent is to inspect, repair or service a product that has come into contact with a hazardous substance such as asbestos, silica dust or other hazardous substance then we may not be able to inspect, service or repair the product. If this is the case, Chervon reserves the right to refuse repair under these circumstances and will inform the customer and the product will be returned at the customer's expense.

EXCLUSIONS

The Warranty does not apply if:

- a) the Product is not supplied in its final shape and form by Chervon or an authorised FLEX Dealer, which can be confirmed on the website store locator (for avoidance of doubt, third party online stores such as eBay, Gumtree, Amazon, etc. are excluded);
- b) the Product is altered, modified or repaired by a party other than Chervon or its agent;
- c) the Product is used other than for its designed purpose;
- d) the Product is used for rental purposes;
- e) the Product is used or installed other than in accordance with Chervon's instructions;
- f) the Product has not been maintained or protected in accordance with Chervon's instructions;
- g) the Product has been subject to abnormal conditions;
- h) the product suffers normal deterioration of the exterior finish, including but not limited to scratches, dents, paint chips, or to any corrosion or discolouring by heat, abrasive and chemical cleaners;
- i) the Product is involved in an accident;
- j) Chervon cannot find any defect in the Product after testing, inspection and assessment;
- k) the alleged defect is due to abuse, misuse, neglect (including failure to clean) or accident;
- l) the alleged defect is due to a failure to properly maintain or use the Product;
- m) the alleged defect in the Product is within acceptable industry standards or tolerances; or
- n) the alleged defect is due to a request to customise the Product;

o) the alleged defect is due to normal wear and tear, misuse or abuse (including overloading of the product beyond capacity and exposure to water or rain);

p) The alleged defect has been used or caused due to continuous industrial use.

The Warranty does not extend to:

a) damage or defects caused by normal wear and tear;

b) the Products being damaged by you or a third party;

c) accidental or wilful damage, or misuse; or

d) theft or vandalism.

This Warranty does not extend to other accessories or attachments.

LIMITATIONS

Chervon makes no express warranties or representations other than as set out in this document.

Chervon will not be liable to you or any other person in connection with this Warranty for any:

a) consequential or indirect loss, damage or costs incurred by you or any other person; or

b) damage to property, loss of turnover, loss of profits, loss of business or loss of good will.

CONTACT

For Warranty Service or to make a claim please contact Chervon on the details below between the hours of Monday to Friday 9:00am to 5:00pm EST/NZST (as applicable)

Chervon Australia Pty Ltd

Unit 14, 5 Kelletts Rd, Rowville, VIC. 3178.

Ph Australia; 1300 000 346. Email: support@flex-tools.com.au

Chervon New Zealand Subsidiary Ltd

4th Floor, Smith & Caughey Building, 253 Queen St, Auckland, 1141.

Ph New Zealand; 0508 000 346. Email: support@flex-tools.com.au

NON REGISTER

REGISTRATION WITHIN 30 DAYS OF PURCHASE

PRODUCT OR MODEL #	LIMITED STANDARD WARRANTY PERIOD	LIMITED WARRANTY PERIOD WITH REGISTRATION WITHIN 30 DAYS FROM DATE OF PURCHASE*
FLEX 24V Lithium-ion power tools	3 Years	5 Years
FLEX 24V Lithium-ion Batteries and Chargers	3 Years	5 Years
FLEX Accessories & Consumables	90 Days	90 Days
FLEX STACK PACK™ Storage system	1 Year	1 Year

*Original purchaser must register the product(s) within 30 days of purchase and retain their receipt as proof of purchase. This warranty applies only to the original purchaser from an authorised FLEX dealer and may not be transferred. If original purchaser does not register their product within 30 days, the warranty will apply for the duration set out in table above in column 'LIMITED STANDARD WARRANTY PERIOD'. For avoidance of doubt please refer to warranty table above and full warranty details in this manual or on our website at www.flex-tools.com.au

FLEX

OPERATOR'S MANUAL

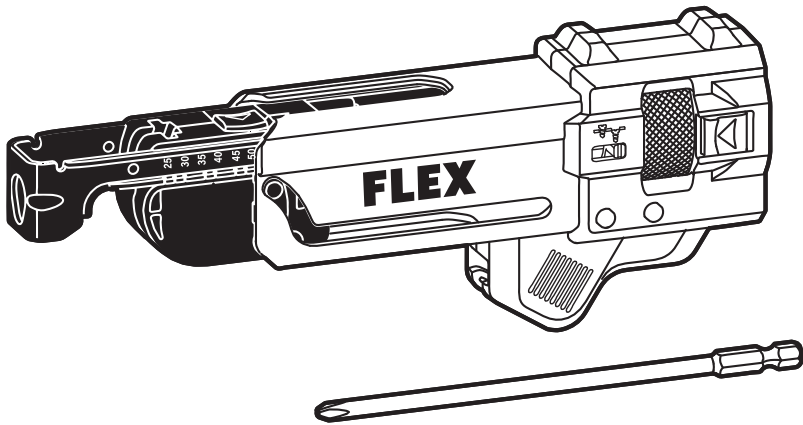

Model: FTA161

COLLATED SCREW MAGAZINE

⚠ WARNING: To reduce the risk of injury, the user must read and understand the Owner's Manual before using this product. Save these instructions for future reference.







Please contact FLEX customer service in Australia 1300 000 346 or
New Zealand 0508 000 346 any time you have questions or warranty claims.

SAFETY SYMBOLS

The purpose of safety symbols is to attract your attention to possible dangers. The safety symbols and the explanations with them deserve your careful attention and understanding. The symbol warnings do not, by themselves, eliminate any danger. The instructions and warnings they give are no substitutes for proper accident prevention measures.

⚠ WARNING Be sure to read and understand all safety instructions in this Operator's Manual, including all safety alert symbols such as "**DANGER**," "**WARNING**," and "**CAUTION**" before using this tool. Failure to follow all instructions listed below may result in electric shock, fire, and/or serious personal injury.

The definitions below describe the level of severity for each signal word. Please read the manual and pay attention to these symbols.	
	This is the safety alert symbol. It is used to alert you to potential personal injury hazards. Obey all safety messages that follow this symbol to avoid possible injury or death.
	DANGER indicates a hazardous situation which, if not avoided, will result in death or serious injury.
	WARNING indicates a hazardous situation which, if not avoided, could result in death or serious injury.
	CAUTION, used with the safety alert symbol, indicates a hazardous situation which, if not avoided, will result in minor or moderate injury.

SAFETY RULES FOR COLLATED SCREW MAGAZINE



WARNING Read all safety warnings, instructions, illustrations and specifications provided with this power tool. Failure to follow all instructions listed below may result in electric shock, fire and/or serious injury.

SAVE ALL WARNINGS AND INSTRUCTIONS FOR FUTURE REFERENCE

The collated screw magazine is designed to only be used with the FLEX FXA1611 brushless drywall screwdriver.

Observe all operating instructions and safety regulations contained in the manual for the FLEX FXA1611 brushless drywall screwdriver.

Before use, ensure that the magazine is properly attached to the power tool.

Avoid body contact with grounded (or earthed) surfaces such as pipes, radiators, ranges and refrigerators. There is an increased risk of electric shock if your body is grounded.

Detach the battery pack from the power tool before making any adjustments, changing accessories, or storing power tools. Such preventive safety measures reduce the risk of

starting the power tool accidentally.

When driving screws, never reach into the magazine. Keep hands clear of the advancing mechanism and the spot where the screw is being driven.

Do not use the magazine as a gripping surface.

Hold power tool by insulated gripping surfaces, when performing an operation where the fastener may contact hidden wiring. Fasteners contacting a "live" wire may make exposed metal parts of the power tool "live" and could give the operator an electric shock.

Use only screw strips with screw sizes #6, #7 and #8 with this magazine. Only insert screw strips when the screwdriver is turned off and the trigger is locked.

FUNCTIONAL DESCRIPTION AND SPECIFICATIONS

Collated Screw Magazine

Fig. 1

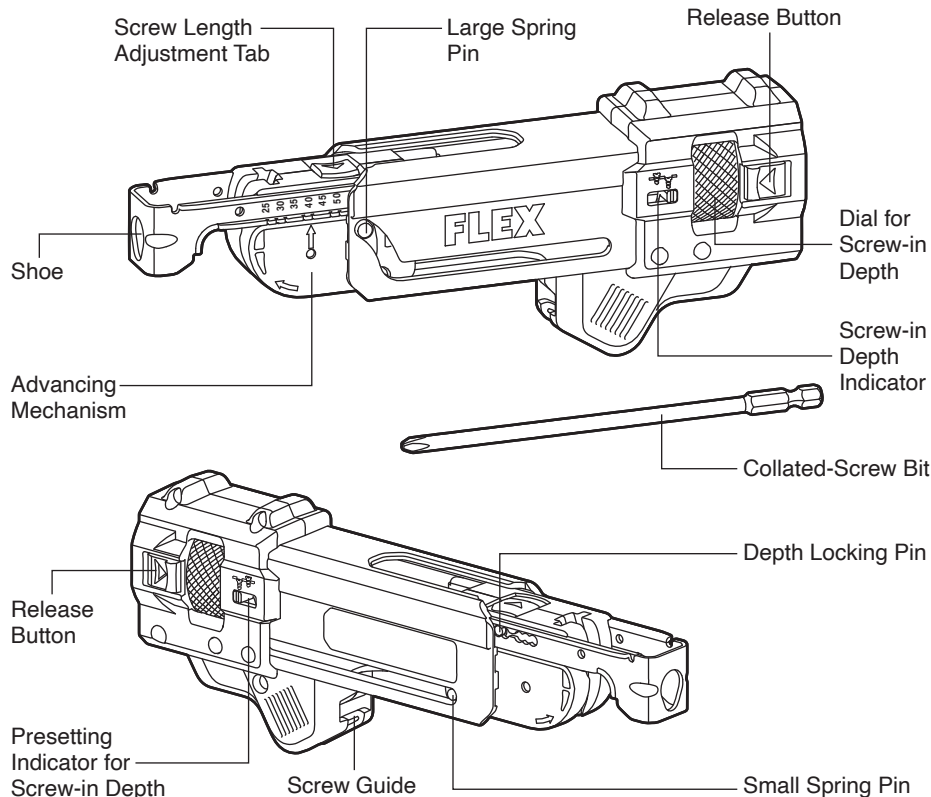

Model No.	FTA161
Magazine Length	211 mm
Collated Screw Length	25 – 55 mm
Collated Screw Size	3.5 – 4.2 mm
Screws Per Strip (max.)	50 pcs

NOTICE: Use only collated screws marked “CS Collated Screws” on the package. Other screws are not compatible with this magazine.

ASSEMBLY

⚠ WARNING Detach the battery pack from the drywall screwdriver before making any assembly, adjustments or changing accessories. Such preventive safety measures reduce the risk of starting the tool accidentally.

⚠ WARNING Lock the variable-speed trigger switch “OFF” by placing the direction-of-rotation selector in the centre position. An accidental start-up can cause injury.

FITTING THE COLLATED SCREW BIT (FIG. 2)

NOTICE: For proper operation only use the collated screw bit with PH2 Ø 5 x 150.

Refer to and follow the instructions on “Changing Bit Holder” in your FLEX FXA1611 brushless drywall screwdriver manual to:

- Remove the stop sleeve from the screwdriver.
- Remove the installed bit holder from the screwdriver.

Fig. 2

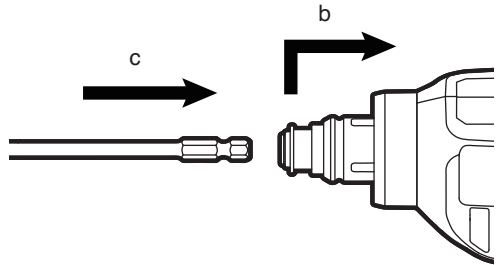

- Push the clutch backward and push the provided collated screw bit into the gearcase.
- Release the clutch and ensure the bit shank is locked in the gearcase securely.

INSTALLING AND REMOVING THE MAGAZINE

To Install the Magazine (Fig. 3)

With the stop sleeve removed and provided collated screw bit installed:

- Push forward and hold the release buttons on both sides of the magazine.
- Align the raised ribs on the screwdriver with the grooves in the magazine, and push the magazine over the bit onto the screwdriver until the magazine audibly snaps into place.
- Let go of the release buttons and ensure that the magazine does not disengage.

NOTE: This attachment has the ability to rotate without being taken off the drywall screwdriver along the drywall screwdriver axis. Refer to the “Rotating the Magazine” chapter in this manual.

To Remove the Magazine

Push forward and hold the release buttons on both sides of the magazine and pull the magazine off of the screwdriver.

Fig. 3

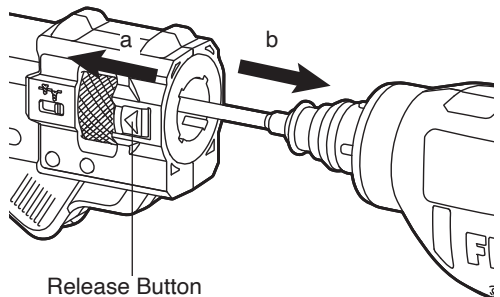

INSERTING COLLATED SCREW STRIP (FIG. 4)

NOTICE: Use only screw strips with screw sizes 3.5 – 4.2 mm with this magazine. Only insert screw strips when the screwdriver is turned off and the trigger switch is locked.

Proper use of collated strips will reduce the risk of injury, reduce jams and prevent screws from damaging the workpiece. For best performance use new, undamaged strips free of debris.

- a. Take a collated strip, holding the plastic portion, and feed from the bottom of the screw guide and into the bottom of the advancing mechanism
- b. Continue feeding the strip until the first screw is one slot below the driver bit.

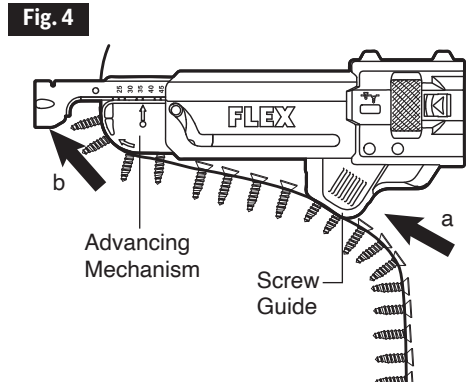

REMOVING THE COLLATED SCREW STRIPS (FIG. 5)

Pull the screw strip up to remove it.

NOTICE: Do not remove the screw strip by forcibly pulling the screw strip downwards to avoid damaging the product or even causing personal injury.

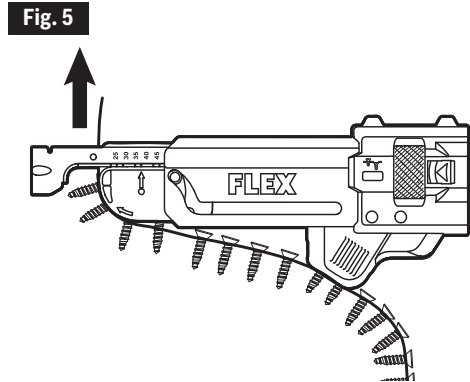

ADJUSTMENTS

⚠ WARNING Detach the battery pack from the drywall screwdriver and lock the variable-speed trigger switch “OFF” by placing the direction-of-rotation selector in the centre position.

SETTING THE SCREW LENGTH

⚠ CAUTION Do not adjust the screw length while a screw strip is in the magazine. Remove the screw strip prior to making adjustments.

This magazine is designed for screws that are 25 – 55 mm long. Failure to set the correct screw length can cause screws to not be driven accurately which can result in the failure to advance the next screw or screws not being screwed-in properly. The shoe has the specific length marks for the most common screw lengths. The arrow points at the length mark indicating the current screw length (Fig. 6a).

- Slide the screw length adjustment tab to the left (Fig. 6a).
- While holding the screw length adjustment tab in place, adjust the shoe to the desired length by pulling the shoe out or pushing it into the magazine until the arrow is aligned with the desired length mark (Fig. 6a).
- Release the screw length adjustment tab. Make sure that the locking pin on the other side of the magazine has fully returned and is in the desired marked depth position (Fig. 6b).

Fig. 6a

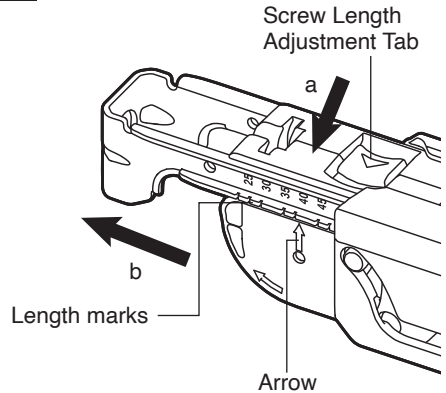
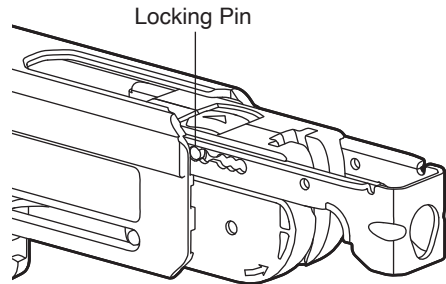

Fig. 6b



SETTING SCREW-IN DEPTH (FIG. 7)

Use the dial for screw-in depth to set the desired screw-in depth.

Turn the dial up (or clockwise) for driving the screws deeper into the workpiece, or down (counterclockwise) to allow more of the screwhead to stick out from the workpiece. The actual setting position is shown on the screw-in depth indicator.

Upon setting, drive some screws for testing and use the dial to adjust the depth, if required.

Fig. 7

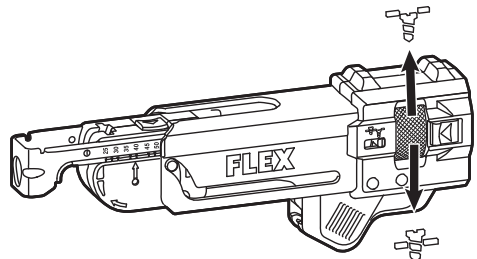

ROTATING THE MAGAZINE (FIG. 8)

This collated magazine has the ability to rotate without being taken off the drywall screwdriver.

To rotate, grip the top portion of the magazine with one hand, while holding the drywall screwdriver with the other hand, then rotate the magazine. An audible “click” indicates that the magazine is positioned at one of 12 detents spaced 30° apart.

Fig. 8

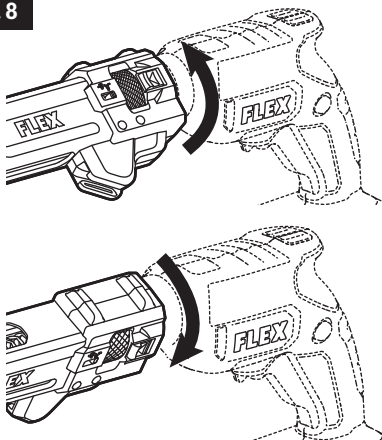

OPERATING INSTRUCTIONS

DRIVING IN SCREWS (FIG. 9)

- Insert the collated screw strip.
- Set the screw-in depth.
- Set the direction of rotation, on your drywall screwdriver, to forward rotation.
- Grip the drywall screwdriver with both hands on the handle and assume working position.
- Place the shoe against the workpiece to be screwed into. Hold the drywall screwdriver at right angle to the workpiece surface
- On your drywall screwdriver: depress and hold down the trigger switch, then press the lock-on button to lock the trigger switch. The screw will be driven into the workpiece until the set screw-in depth is reached. Check the screw-in depth and change if required.

NOTE: When the preset screw-in depth is reached, the drive is disengaged and the bit will stop spinning while the motor is still running.

- Repeat the operation to drive more screws.
- When you have finished driving screws, turn off the drywall screwdriver.

At the end of work, move the direction-of-rotation selector, on the drywall screwdriver, to the middle position.

Fig. 9

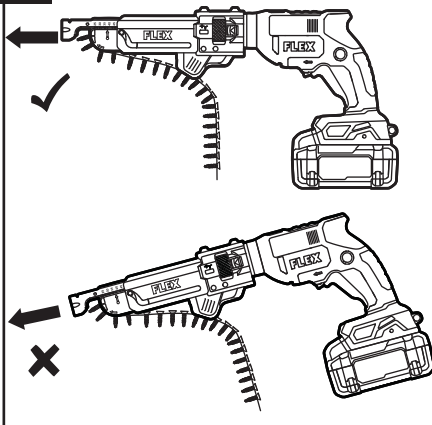

MAINTENANCE

⚠ WARNING Disconnect the collated screw magazine from the drywall screwdriver prior to performing maintenance or cleaning.

SERVICE

⚠ WARNING Preventive maintenance performed by unauthorized personnel may result in misplacing of internal wires and components which could cause a serious hazard. We recommend that all tool service be performed by a FLEX Factory Service Centre or Authorized FLEX Service Station.

GENERAL MAINTENANCE

⚠ WARNING When servicing, use only identical replacement parts. Use of any other parts could create a hazard or cause product damage. Periodically

inspect the entire product for damaged, missing, or loose parts such as screws, nuts, bolts, caps, etc. Tighten securely all fasteners and caps and do not operate this product until all missing or damaged parts are replaced. Please contact customer service or an authorized service centre for assistance.

CLEANING

Use a brush and blow dust and debris out of the main housing with dry compressed air as needed.

⚠ WARNING Wear appropriate eye protection and dust mask when using compressed air.

⚠ WARNING Never use solvents or other harsh chemicals for cleaning the non-metallic parts of the magazine. These chemicals may weaken the materials used in these parts.

To remove dust and debris from the interior of the magazine, follow the steps below:

REMOVING AND INSTALLING THE ADVANCING MECHANISM

⚠ CAUTION The advancing mechanism is spring loaded. Always use both hands to remove the advancing mechanism. The return spring may eject from the mechanism.

TO REMOVE THE ADVANCING MECHANISM (FIG. 10a & 10b)

- Disconnect the magazine from the screwdriver.
- Depress and hold the large spring pin.
- Turn over the magazine and depress and hold the small spring pin.
- Pull the advancing mechanism off the magazine

Fig. 10a

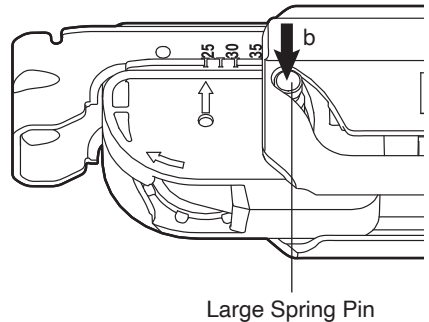
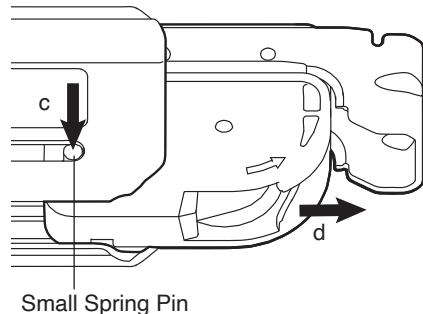

Fig. 10b



TO INSTALL THE ADVANCING MECHANISM (FIG. 10c)

Fig. 10c

- With the magazine attachment removed from screwdriver, align the tabs on the shoe with the slots in the magazine housing.
- Push in slightly, then align the return spring with the pocket in the advancing mechanism.
- Push the advancing mechanism in and depress the large spring pin and the small spring pin on both sides at the same time, until you hear the “click” of the two spring pins releasing.

NOTE: The large spring pin should be in the up position (as shown in Fig. 10c) before the advancing mechanism is installed. If the large spring pin is in the down position, the advancing mechanism will be locked in place.

- Cycle the advancing mechanism several times by hand to ensure proper function before installing the magazine onto your screwdriver for use.

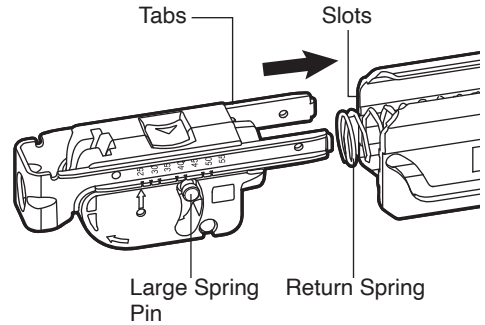

STORAGE

Store the collated screw magazine indoors in a place that is inaccessible to children. Keep away from corrosive agents.

ACCESSORIES

⚠ WARNING The use of any other accessories not specified in this manual may create a hazard.

Collated screwdriver bit

WARRANTY STATEMENT

Chervon Australia Pty Ltd (ABN 36 165 077 501) of Unit 14,5 Kelletts Road, Rowville, Victoria, 3178, and Chervon New Zealand Subsidiary Ltd (NZBN 9429049277616) (**Chervon**) provides the following warranty (**Warranty**) to original domestic purchasers in Australia and New Zealand as applicable (**Customers**) of its FLEX24V Tools, FLEX24V Batteries and Chargers and FLEX STACK PACK Storage System (collectively **Products**).

The benefits of this Warranty are in addition to any rights and remedies imposed by Australian State and Federal or New Zealand legislation that cannot be excluded. Nothing in this Warranty is to be interpreted as excluding, restricting or modifying any legislation relevant to the supply of goods and services in Australia or New Zealand, as applicable, which cannot be excluded, restricted or modified.

In Australia, if the claimant is a “consumer” under the Australian Consumer Law, Chervon confirms the following:

Our goods come with guarantees that cannot be excluded under the Australian Consumer Law. You are entitled to a replacement or refund for a major failure and compensation for any other reasonably foreseeable loss or damage. You are also entitled to have the goods repaired or replaced if the goods fail to be of acceptable quality and the failure does not amount to a major failure.

WARRANTY

Chervon warrants that, subject to the terms of this Warranty and the exclusions and limitations contained herein, the Products will be free from defects in materials and workmanship for the following period, as applicable, calculated from the date of purchase of the Product (**Warranty Period**):

- If the Customer registers its purchase of the Product online at www.flex-tools.com.au or by calling 1300 000 346 in Australia or www.flex-tools.co.nz or by calling 0508 000 346 in New Zealand within 30 days of the date of its purchase (**Registration**), the Warranty Period for the following Products is as follows:
 - FLEX 24V Tools: 5 years;
 - FLEX 24V Batteries and Chargers: 5 years;
 - FLEX Stack Pack™ Storage System: 1 year;
 - FLEX Accessories & Consumables: 90Days
- If the Customer fails to complete Registration as outlined above, the Warranty Period for the following Products is as follows:
 - FLEX 24V Tools: 3 years;
 - FLEX 24V Batteries and Chargers: 3 years;
 - FLEX Stack Pack™ Storage System: 1 year;
 - FLEX Accessories & Consumables: 90 Days

For further clarification and avoidance of doubt please refer to the FLEX product warranty table included below.

If, before the end of the Warranty Period, a defect appears in the manufacture or assembly of a Product, and Chervon finds the Product to be defective in materials or workmanship, it will, in its sole discretion, either:

- replace or repair the Product or the defective part of the Product free of charge; or
- cause the Product or the defective part of the Product to be replaced or repaired free of charge.

Chervon reserves the right to replace a defective Product or part of a Product with parts and components of similar quality, grade and composition where an identical part or component is not available. Where the product is repaired, Chervon may use refurbished parts.

WARRANTY CLAIMS

1. If a defect covered by Warranty appears, you must first contact Chervon:
 - a) by telephone on 1300 000 346 (AU); or 0508 000 346 (NZ); or
 - b) by email at support@flex-tools.com.au
2. Any Warranty claim must be accompanied by:
 - a) proof of purchase;
 - b) full details of the alleged defect;
 - c) photo evidence of the alleged defect; and
 - d) any other relevant documents.
3. You must allow Chervon or its authorised agent to inspect and test the Product. If that inspection and test finds no defect in the Product, you must pay Chervon's usual service and testing costs.
4. Unless otherwise agreed in writing by Chervon, you must pay the cost of transporting the Product to and from Chervon or Chervon's authorised agent and any related insurance cost. Any handling and transportation costs (and other expenses incurred in claiming this warranty) are not covered by this warranty and will not be borne by Chervon.
5. The replacement product or part, or repaired product will be made available for your collection at an address nominated by Chervon.
6. Customers are responsible for the care and cleaning of their product prior to sending it to back to Chervon or its nominated authorised repair agents. Any product being sent for repair must be cleaned. It is an Occupational/Work Health and Safety risk for our staff or authorised repairers to inspect, repair or service a product that has come into contact with a hazardous substance.
7. If Chervon or its authorised repair agent is to inspect, repair or service a product that has come into contact with a hazardous substance such as asbestos, silica dust or other hazardous substance then we may not be able to inspect, service or repair the product. If this is the case, Chervon reserves the right to refuse repair under these circumstances and will inform the customer and the product will be returned at the customer's expense.

EXCLUSIONS

The Warranty does not apply if:

- a) the Product is not supplied in its final shape and form by Chervon or an authorised FLEX Dealer, which can be confirmed on the website store locator (for avoidance of doubt, third party online stores such as eBay, Gumtree, Amazon, etc. are excluded);
- b) the Product is altered, modified or repaired by a party other than Chervon or its agent;
- c) the Product is used other than for its designed purpose;
- d) the Product is used for rental purposes;
- e) the Product is used or installed other than in accordance with Chervon's instructions;
- f) the Product has not been maintained or protected in accordance with Chervon's instructions;
- g) the Product has been subject to abnormal conditions;
- h) the product suffers normal deterioration of the exterior finish, including but not limited to scratches, dents, paint chips, or to any corrosion or discolouring by heat, abrasive and chemical cleaners;
- i) the Product is involved in an accident;
- j) Chervon cannot find any defect in the Product after testing, inspection and assessment;
- k) the alleged defect is due to abuse, misuse, neglect (including failure to clean) or accident;
- l) the alleged defect is due to a failure to properly maintain or use the Product;
- m) the alleged defect in the Product is within acceptable industry standards or tolerances; or
- n) the alleged defect is due to a request to customise the Product;

o) the alleged defect is due to normal wear and tear, misuse or abuse (including overloading of the product beyond capacity and exposure to water or rain);

p) The alleged defect has been used or caused due to continuous industrial use.

The Warranty does not extend to:

a) damage or defects caused by normal wear and tear;

b) the Products being damaged by you or a third party;

c) accidental or wilful damage, or misuse; or

d) theft or vandalism.

This Warranty does not extend to other accessories or attachments.

LIMITATIONS

Chervon makes no express warranties or representations other than as set out in this document.

Chervon will not be liable to you or any other person in connection with this Warranty for any:

a) consequential or indirect loss, damage or costs incurred by you or any other person; or

b) damage to property, loss of turnover, loss of profits, loss of business or loss of good will.

CONTACT

For Warranty Service or to make a claim please contact Chervon on the details below between the hours of Monday to Friday 9:00am to 5:00pm EST/NZST (as applicable)

Chervon Australia Pty Ltd

Unit 14, 5 Kelletts Rd, Rowville, VIC. 3178.

Ph Australia; 1300 000 346. Email: support@flex-tools.com.au

Chervon New Zealand Subsidiary Ltd

4th Floor, Smith & Caughey Building, 253 Queen St, Auckland, 1141.

Ph New Zealand; 0508 000 346. Email: support@flex-tools.com.au

NON REGISTER

REGISTRATION WITHIN 30 DAYS OF PURCHASE

PRODUCT OR MODEL #	LIMITED STANDARD WARRANTY PERIOD	LIMITED WARRANTY PERIOD WITH REGISTRATION WITHIN 30 DAYS FROM DATE OF PURCHASE*
FLEX 24V Lithium-ion power tools	3 Years	5 Years
FLEX 24V Lithium-ion Batteries and Chargers	3 Years	5 Years
FLEX Accessories & Consumables	90 Days	90 Days
FLEX STACK PACK™ Storage system	1 Year	1 Year

*Original purchaser must register the product(s) within 30 days of purchase and retain their receipt as proof of purchase. This warranty applies only to the original purchaser from an authorised FLEX dealer and may not be transferred. If original purchaser does not register their product within 30 days, the warranty will apply for the duration set out in table above in column 'LIMITED STANDARD WARRANTY PERIOD'. For avoidance of doubt please refer to warranty table above and full warranty details in this manual or on our website at www.flex-tools.com.au

