

**FLEX**

# PIPE BELT SANDER / BELT FILE

**BRE 8-4**

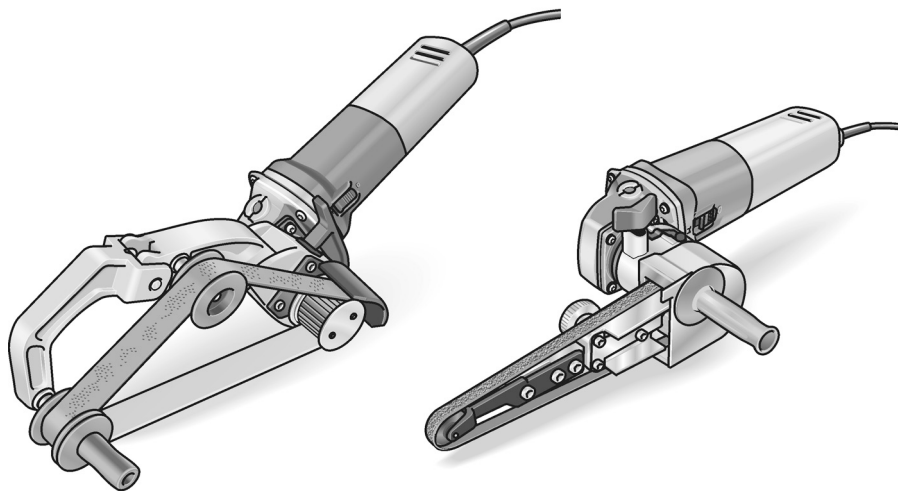

## Contents

Symbols used in this manual	2
Symbols on the power tool	2
For your safety	2
Noise and vibration	4
Technical specifications	5
Overview	6
Instructions for use	7
Maintenance and care	11
Disposal information	12
Exemption from liability	12

## Symbols used in this manual



### **WARNING!**

Denotes impending danger. Non-observance of this warning may result in death or extremely severe injuries.



### **CAUTION!**

Denotes a possibly dangerous situation. Non-observance of this warning may result in slight injury or damage to property.



### **NOTE**

Denotes application tips and important information.

## Symbols on the power tool



Before switching on the power tool, read the operating manual!



Wear goggles!



Protection class II  
(completely insulated)



Disposal information for the old machine (see page 12)

## For your safety



### **WARNING!**

Before using the angle grinder, please read and follow:

- these operating instructions,
- the “General safety instructions” on the handling of power tools in the enclosed booklet (leaflet-no.: 515.906),
- the currently valid site rules and the regulations for the prevention of accidents.

This angle grinder is state of the art and has been constructed in accordance with the acknowledged safety regulations.

Nevertheless, when in use, the power tool may be a danger to life and limb of the user or a third party, or the power tool or other property may be damaged. The angle grinder may be operated only if it is

- as intended,
- in perfect working order.

Faults which impair safety must be repaired immediately.

### **Intended use**

The drive unit BME 8-4 must be used solely as a drive for the attachments described below.

### **With the belt sander attachment BRE 8-4 the power tool is intended**

- for commercial use in industry and trade,
- for finishing stainless steel pipes, round railing parts,
- for sanding round bar profiles as well as pipes in general,
- for use with sanding belts and accessories which are specified in these instructions or recommended by the manufacturer.

### **With the belt grinder attachment FBE 8-4 the power tool is intended**

- for commercial use in industry and trade,
- for grinding and polishing metallic surfaces in areas with limited access,
- for use with sanding belts and accessories which are specified in these instructions or recommended by the manufacturer.

## Safety Instructions for power tools with a pipe belt sander attachment



### **WARNING!**

**Read all safety warnings and all instructions.** Failure to follow the warnings and instructions may result in electric shock, fire and/or serious injury. **Save all warnings and instructions for future reference.**

- **Hold the device by the insulated grip surfaces, as the sanding belt may come into contact with the power cord itself.** A damaged live cable may cause metal parts of the device to become live and result in an electric shock.
- **Do not use the electric power tool if it has a damaged power cord. Do not touch the damaged power cord and pull out the mains plug if the power cord is damaged during work.** Damaged power cords increase the risk of an electric shock.
- **Use the electric power tool for dry sanding only.** If water penetrates the electric power tool, there is an increased risk of electric shock.
- **When working, guide the electric power tool with both hands. The handle must be attached!** Do not switch on the machine until both hands are in the grip position.
- **Keep hands away from the running sanding belt. There is a risk of injury caused by crushing in the area of the guide rollers.** On account of the operating mode and the guaranteed flexibility of the power tool these danger areas cannot be completely shielded.
- **Dust released from materials, such as lead paints, some types of wood, minerals and metal, may be hazardous to the operator or people in the vicinity.** Inhaling or touching these dusts may result in respiratory diseases and/or allergic reactions.
  - Ensure the work place is well ventilated!
  - If possible, use external dust extraction.
  - It is recommended to wear a respirator mask belonging to filter class P2.
- **Do not work on materials which release hazardous substances (e.g. asbestos).**
- **Never grind or cut light metals which have a magnesium content greater than 80%. Risk of fire!**
- **If power tools are used outdoors or are exposed to excessive amounts of metal**

dust, connect them via a residual-current-operated circuit-breaker (tripping current maximum 30 mA). Do not use any worn, torn or severely clogged sanding belts. Damaged sanding belts may rip, fly off and cause an injury.

- Before using the machine, check that the grinding tools have been installed and secured correctly. Switch on the machine at no load for 30 seconds!
- Interrupt the test run immediately if violent vibrations occur or other damage is established. Check the machine to determine the cause.
- Do not load electric power tool to such an extent that it comes to a standstill or the sanding belt slips.
- Before putting down the electric power tool, switch it off and wait until it comes to a standstill.
- Do not clamp the electric power tool in a vice.
- Always lay the power cord to the rear away from the electric power tool.
- Clamp the workpiece if it is loose or not positioned securely by its own weight.
- Store and handle grinding tools according to the manufacturer's instructions.

## Safety instructions for power tool with belt grinder attachment



### **WARNING!**

**Read all safety instructions and other instructions.** Failure to observe the safety instructions and other instructions may result in an electric shock, fire and/or serious injuries. **Keep all safety instructions and other instructions in a safe place for the future.**

- **Hold the device by the insulated grip surfaces, as the sanding belt may come into contact with the power cord itself.** A damaged live cable may cause metal parts of the device to become live and result in an electric shock.
- **Do not use the electric power tool if it has a damaged power cord. Do not touch the damaged power cord and pull out the mains plug if the power cord is damaged during work.** Damaged power cords increase the risk of an electric shock.

- **Use the electric power tool for dry sanding only.** If water penetrates the electric power tool, there is an increased risk of electric shock.
- **When working, guide the electric power tool with both hands.** The handle must be attached! Do not switch on the machine until both hands are in the grip position.
- **Keep hands away from the running sanding belt. There is a risk of injury caused by crushing in the area of the guide rollers.** On account of the operating mode and the guaranteed flexibility of the power tool these danger areas cannot be completely shielded.
- **Dust released from materials, such as lead paints, some types of wood, minerals and metal, may be hazardous to the operator or people in the vicinity. Inhaling or touching these dusts may result in respiratory diseases and/or allergic reactions.**
  - Ensure the work place is well ventilated!
  - If possible, use external dust extraction.
  - It is recommended to wear a respirator mask belonging to filter class P2.
- Do not work on materials which release hazardous substances (e.g. asbestos).
- Never grind or cut light metals which have a magnesium content greater than 80%. Risk of fire!
- If power tools are used outdoors or are exposed to excessive amounts of metal dust, connect them via a residual-current-operated circuit-breaker (tripping current maximum 30 mA). Do not use any worn, torn or severely clogged sanding belts. Damaged sanding belts may rip, fly off and cause an injury.
- Before using the machine, check that the grinding tools have been installed and secured correctly. Switch on the machine at no load for 30 seconds!
- Interrupt the test run immediately if violent vibrations occur or other damage is established. Check the machine to determine the cause.
- Do not place the power tool under such load that it comes to a halt or the sanding belt slips.

- Before putting down the power tool, switch it off and wait until it comes to a standstill.
- Do not clamp the power tool in a vice.
- Always lay the power cord to the rear away from the electric power tool.
- Clamp the workpiece if it is loose or not positioned securely by its own weight.
- Store and handle grinding tools according to the manufacturer's instructions.

### Additional safety instructions

- Use only extension cables permitted for outdoor use.
- Identify the power tool with stickers only. Do not drill any holes into the housing.
- The mains voltage and the voltage specifications on the rating plate must correspond.
- Recommendation that the tool always be supplied via a residual current device having a rated residual current of 30 mA or less.

### Noise and vibration



#### NOTE

*Values for the A-weighted sound pressure level and for the total vibration values can be found in the "Technical specifications" table.*

*The noise and vibration values have been determined in accordance with EN 60745.*



#### CAUTION!

*The indicated measurements refer to new power tools. Daily use causes the noise and vibration values to change.*



#### NOTE

The vibration emission level given in this information sheet has been measured in accordance with a standardised test given in EN 60745 and may be used to compare one tool with another. It may be used for a preliminary assessment of exposure. The declared vibration emission level represents the main applications of the tool. However if the tool is used for different applications, with different accessories or poorly maintained, the vibration emission may differ. This may significantly increase the exposure level over the total working period.

However if the tool is used for different applications, with different accessories or

## BRE 8-4

en

poorly maintained, the vibration emission may differ. This may significantly decrease the exposure level over the total working period.

Identify additional safety measures to protect the operator from the effects of vibration such as: maintain the tool and the accessories, keep the hands warm, organisation of work patterns.

**CAUTION!**

*Wear ear protection at a sound pressure above 85 dB(A).*

## Technical specifications

Machine type		Pipe belt sander BRE 8-4	Belt grinder FBE 8-4
Mains voltage	V	240	
Power input	W	800	
Power output	W	325	
Rated speed	r.p.m.	4500	
No load speed	r.p.m.	1400-4000	
Belt dimensions (length x width)	mm	533x4-30	533x4-9
Belt speed	m/s	3-8	
<b>Weight according to "EPTA Procedure 01/2003"</b>			
Drive without attachments cable	kg	1.8	
Drive with attachment (without cable)	kg	2.7	2.6
Schutzklasse		II/□	
<b>A-weighted sound pressure level according to EN 60745 (see "Noise and vibration "):</b>			
Sound pressure level L <sub>pA</sub>	dB(A)	81.6	81.4
Sound power level L <sub>WA</sub>	dB(A)	92.6	92.4
Uncertainty K	db	3.0	
<b>Total vibration value according to EN 60745 (see "Noise and vibration"):</b>			
Emission value a <sub>h</sub> when sanding metal pipes	m/s <sup>2</sup>	< 2.5	< 2.5
Uncertainty K	m/s <sup>2</sup>	1.5	

## Overview

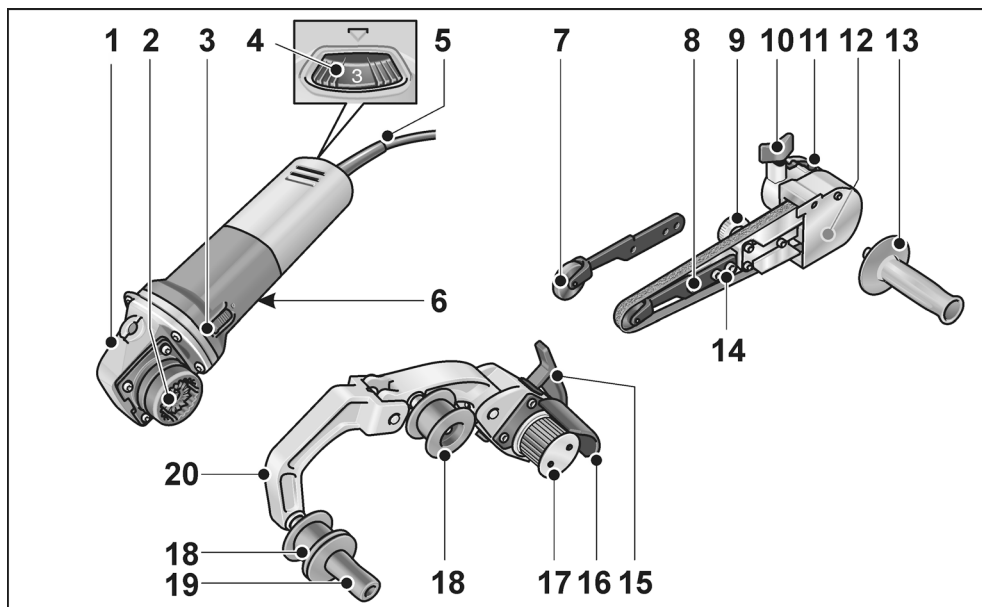

### Drive unit BME 8-4

- 1 Gear head
- 2 Snap coupling for attachments
- 3 Switch rocker  
Switches the power tool on and off.  
With notched position for continuous operation.
- 4 Dial for preselecting the speed
- 5 4,0 m power cord with plug
- 6 Rating plate \*)

### Belt grinder attachment FBE 8-4

- 7 Contact roller with sanding arm
- 8 Securing bolt/adjusting bolt for setting belt course
- 9 Eccentric bolt
- 10 Locking bolt for sanding attachment
- 11 Release lever for snap coupling
- 12 Housing cover
- 13 Handle
- 14 Securing bolts for sanding arm

### Pipe belt sander attachment BRE 8-4

- 15 Clamping lever for snap coupling
- 16 Protective cover
- 17 Drive roller with thrust rings
- 18 Idler with thrust rings
- 19 Handle
- 20 Swing arm  
Spring-mounted, for tensioning the sanding belt.

\*) not illustrated

## Instructions for use



### **WARNING!**

*Before performing any work on the electric power tool, pull out the mains plug.*

### **Before switching on the power tool**

Unpack the drive unit and attachments, and check that no parts are missing or were damaged during transport.

### **Mounting attachments**

- Place the required attachment on a level work surface with the snap coupling facing upwards.

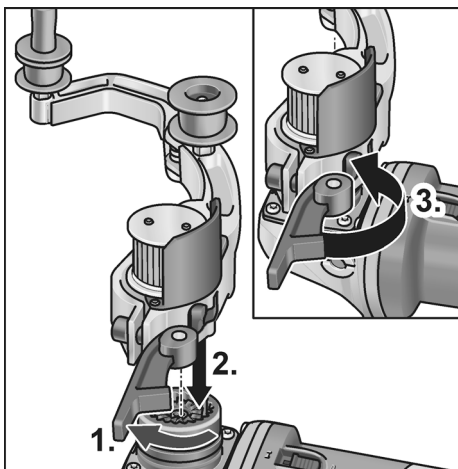

- Open the clamping lever on the attachment (1.).
- Place the drive unit in the required position to the attachment and press down until it audibly engages (2.).
- Close the clamping lever (3.).



### **NOTE**

*The gear teeth in the snap coupling of the drive unit and the attachment are automatically interlocked when the machine is switched on.*

## Removal of attachments

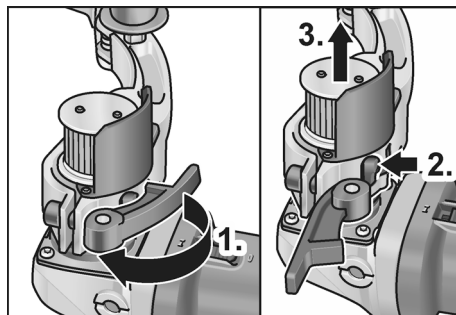

- Open the clamping lever on the attachment (1.).
- Press and hold down the release lever (2.).
- Lift the drive unit off the attachment (3.).
- Loosen locking bolt on attachment (1.).
- Push and hold down release lever (2.).
- Lift up attachment (3.).

## Belt sander attachment BRE 8-4



### **WARNING!**

*Before performing any work on the electric power tool, pull out the mains plug.*

### **Attaching or changing the sanding belt**



### **CAUTION!**

*Observe the specified running direction of the belt! Running direction must correspond with the arrow on the gear head.*

- Pull out the mains plug.
- Press the swing arm towards the rubber drive roller and hold down (1.).

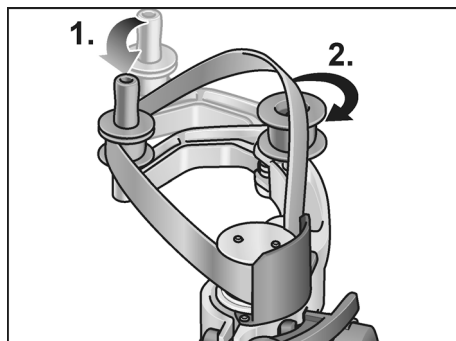

- Place the sanding belt over the rollers (2.).
- Release the swing arm.
- Check that the belt is situated fully on the rollers.



## Adjusting the handle

Bring the handle into position on the thread.

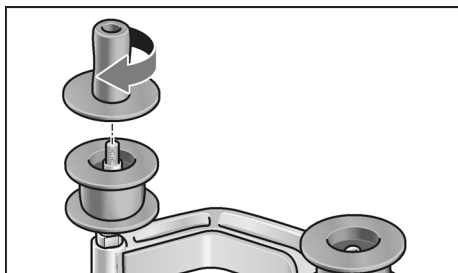

## Change the rollers

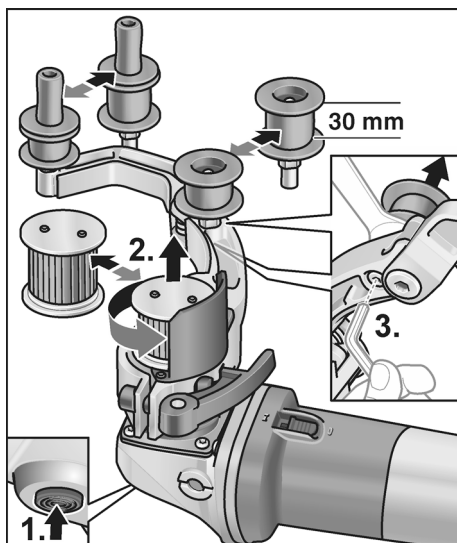

### Drive roller:

- Press and hold down the spindle lock (1.).
- Loosen the drive roller against the direction of rotation and pull off (2.).
- Fit a new drive roller and tighten in direction of rotation.
- Release spindle lock.

### Idler:

- Loosen bolt using hexagon key and pull off idler (3.).
- Fit new idler and tighten.

## Work instructions for the pipe belt sander attachment



### NOTE

*When the appliance is switched off, the grinding tool continues running briefly.*

A belt sander has the following advantages over a grinding disc:

- cool sanding,
- clean finish without grooves,
- high stock removal rate,
- high productivity on account of large angle of contact (depending on diameter).

### Sanding:



### NOTE

*After placing the machine on the workpiece and before switching it on, check that the belt is situated fully on the rollers.*

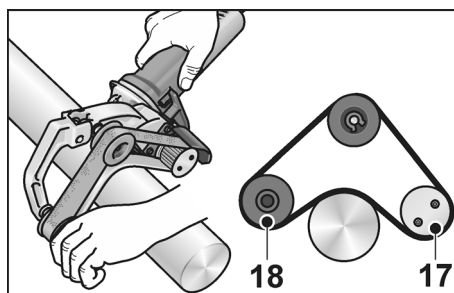

- Pipes are machined between the rollers 17 and 18.
- The angle of contact and the stock removal rate can be varied by the contact pressure.
- The smaller the pipe diameter, the larger the possible angle of contact. Up to 270° are possible.

### Sealing the surface:

Many manufacturers recommend sealing finished surfaces with a protective spray (see Flex stainless steel accessories).

For further information on the manufacturer's products go to [www.flex-tools.com](http://www.flex-tools.com).



## Belt grinder attachment FBE 8-4

### **WARNING!**

Before performing any work on the electric power tool, pull out the mains plug.

### Attaching or changing the sanding belt

- Pull out the mains plug.

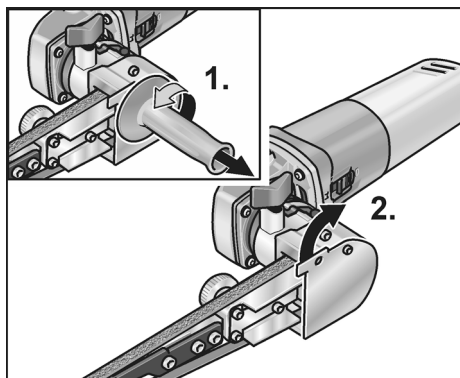

- Remove handle (1.).
- Swivel the housing cover to the side (2.).

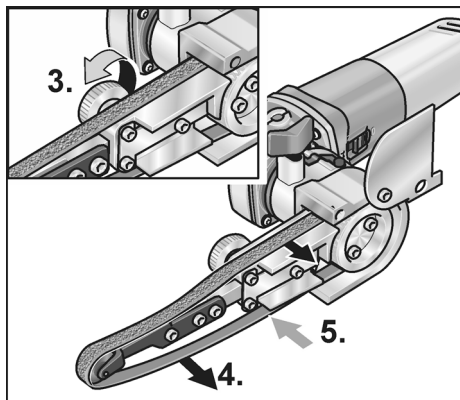

- Turn eccentric screw and release sanding belt (3.).
- Remove sanding belt (4.) (optional).
- Pull on new sanding belt and position centrally on the sanding arm (5.).
- Tighten sanding belt by turning the eccentric screw.
- Close housing cover in front of the housing again.



### **CAUTION!**

Observe the specified running direction of the belt! Running direction must correspond with the arrow on the gear head.

### Attach the handle

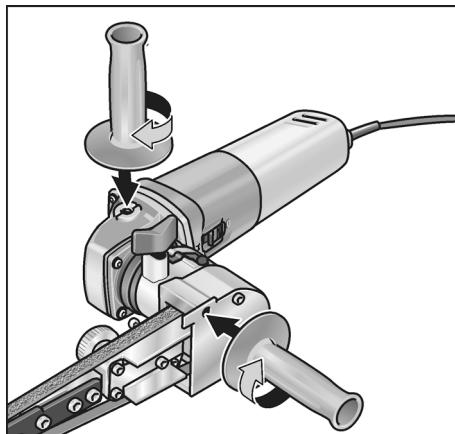

- Attach the auxiliary handle to the thread in position 1 or 2.

### Adjusting the belt run

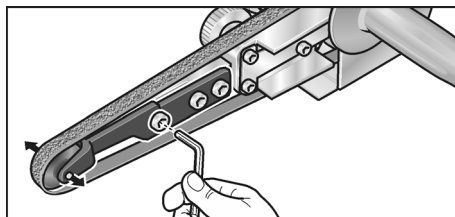

- Adjust the belt run using the front screw on the sanding arm. While the belt is running, select the setting so that the belt runs in the centre of the pressure roller.

### Changing the sanding arm

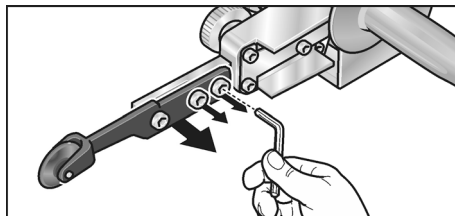

- To change the sanding arm, loosen the three fastening screws.
- Remove sanding arm.
- Attach new sanding arm using the three screws.

## Operating instructions



### NOTE

When the electric power tool is switched off, it continues running briefly.

## Sanding

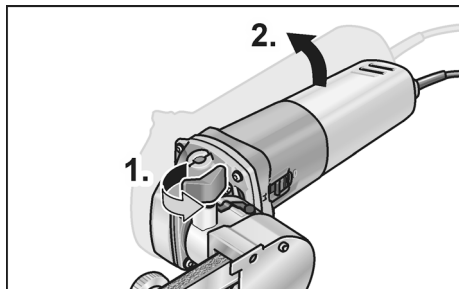

- When the locking screw (1.) is undone, the swivel arm can be tilted up to 140° (2.). As a result, the belt file can also be used for surfaces which are difficult to access, e.g. the insides of pipes.
- Vary the removal rate via the contact pressure. Ensure that the contact pressure is even and not too heavy. If the contact pressure is too high, the sanding belt may slip off the roller.

## Switching on and off

### Brief operation without engaged switch

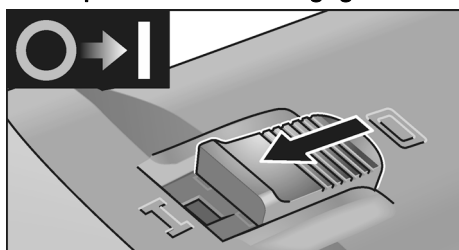

- Push the switch rocker forwards and hold in position.
- To switch off the power tool, release the switch rocker.

## Continuous operation with engaged switch

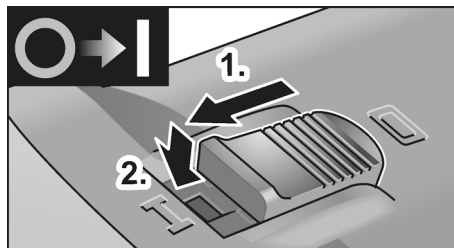

- Push the switch rocker forwards (1.) and engage by pressing the front end (2.).

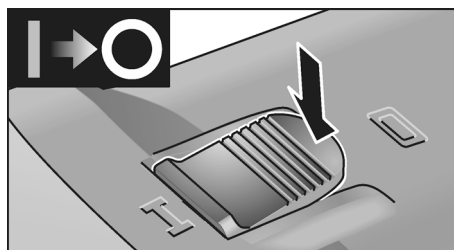

- To switch off the power tool, release the switch rocker by pressing the rear end.



### NOTE

Following a power failure, the switched on power tool does not restart.

## Preselecting the speed

The adjusting wheel enables the operating speed to be continuously adapted to the material requirements.

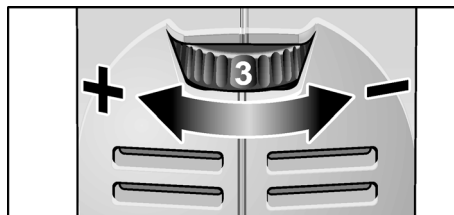

Setting	Belt speed belt sander attachment
	Belt grinder attachment [m/s]
1	2.7
2	3.3

Setting	Belt speed belt sander attachment Belt grinder attachment [m/s]
3	4.7
4	6.3
5	7.4
6	8.1

## Maintenance and care



### **WARNING!**

Before performing any work on the electric power tool, pull out the mains plug.

### **Cleaning**



### **WARNING!**

If metals are ground or cut over a prolonged period, conductive dust may become deposited inside the housing. Impairment of the protective insulation! Operate the power tool via a residual-current-operated circuit-breaker (tripping current 30 mA).

- Regularly clean the power tool and ventilation slots. Frequency of cleaning is dependent on the material and duration of use.
- Regularly blow out the housing interior and motor with dry compressed air.

### **Carbon brushes**

The drive unit is fitted with cut-off carbon brushes. When the cut-off carbon brushes reach their wear limit, the power tool switches off automatically.



### **NOTE**

Use only original parts supplied by the manufacturer for replacement purposes. If non-original parts are used, the guarantee obligations of the manufacturer will be deemed null and void.

When the power tool is being used, the carbon brushes can be seen sparking through the rear air inlet apertures. If the carbon brushes are sparking excessively, switch off the power tool immediately. Take the drive unit to a customer service centre authorised by the manufacturer.

### **Gears**



### **NOTE**

Do not loosen the screws on the gear head during the warranty period. Non-compliance will deem the guarantee obligations of the manufacturer null and void.

### **Repairs**

If the replacement of the supply cord is necessary, this has to be done by the manufacturer or his agent in order to avoid a safety hazard.

Repairs may be carried out by an authorised customer service centre only.

### **Replacing wearing parts**

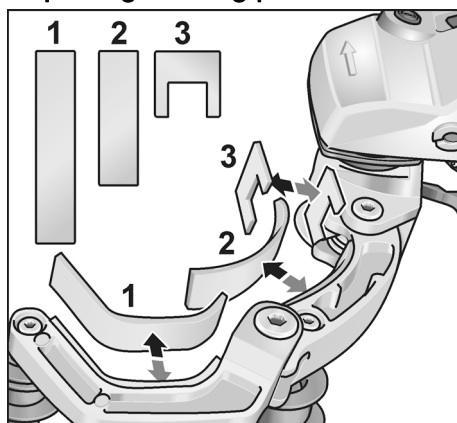

During the operating time of the belt sander the felt pads on the swing arm wear out.

Spare parts are available from the manufacturer or your dealer.

### **Spare parts and accessories**

For other accessories, in particular grinding tools, see the manufacturer's catalogues.

Exploded drawings and spare-part lists can be found on our homepage:

[www.flex-tools.com](http://www.flex-tools.com)

## Disposal information



### **WARNING!**

*Render redundant power tools unusable by removing the power cord.*



EU countries only

Do not throw electric power tools into the household waste!

In accordance with the European Directive 2012/19/EU on Waste Electrical and Electronic Equipment and transposition into national law used electric power tools must be collected separately and recycled in an environmentally friendly manner.



### **NOTE**

*Please ask your dealer about disposal options!*

## Exemption from liability

The manufacturer and his representative are not liable for any damage and lost profit due to interruption in business caused by the product or by an unusable product.

The manufacturer and his representative are not liable for any damage which was caused by improper use of the product or by use of the product with products from other manufacturers.

## FLEX WARRANTY POLICY

For warranty service, please contact FLEX customer service on Australia 1300 000 346 or New Zealand 0508 000 346.

Chervon Australia Pty Ltd ABN 36 165 077 501 and Chervon New Zealand Subsidiary Ltd NZBN 9429049277616 ("Chervon") warrants to the original domestic purchaser that this product will be free from defects in materials and workmanship for 2 years from date of purchase and an additional 1 Year (For a total of 3 Years) with registration via **[www.flex-tools.com.au](http://www.flex-tools.com.au)** or **[www.flex-tools.co.nz](http://www.flex-tools.co.nz)** within 30 days of the original purchase. To make a claim, return the faulty item together with proof of purchase directly to your closest service agent or to the place of purchase. Any handling and transportation costs (and other expenses incurred in claiming this warranty) are not covered by this warranty and will not be borne by Chervon. The replacement product or part or repaired product will be made available for your collection at an address nominated by Chervon. Where a valid warranty claim is made, Chervon will replace the defective product or repair the fault. Where the product is repaired, Chervon may use refurbished parts. This warranty does not cover normal wear and tear, misuse, abuse, or continuous industrial use. This warranty only applies to product purchased by you, inside Australia or New Zealand from authorised Australian or New Zealand FLEX dealers. This warranty may also be further limited or voided as specifically detailed in the product Manual. Chervon has no other liability under this warranty. The benefits to you given by this warranty are in addition to other rights and remedies imposed by State and Federal legislation that cannot be excluded. Our goods come with guarantees that cannot be excluded under the Australian Consumer Law and the New Zealand Consumer Guarantee Act 1993. You are entitled to a replacement or refund for a major failure and compensation for any other reasonably foreseeable loss or damage. You are also entitled to have the goods repaired or replaced if the goods fail to

be of acceptable quality and the failure does not amount to a major failure. Chervon Australia Pty Ltd, Unit 14, 5 Kelletts Rd, Rowville, VIC 3178. Chervon New Zealand Subsidiary Ltd, 4th Floor, Smith & Caughey Building, 253 Queen St, Auckland, 1141 Ph: 1300 000 346.  
Email: **[support@flex-tools.com.au](mailto:support@flex-tools.com.au)**

# FLEX

Chervon Australia Pty Ltd,  
Unit 14, 5 Kelletts Road, Rowville, VIC 3178.

Email: [support@flex-tools.com.au](mailto:support@flex-tools.com.au)

[www.flex-tools.com.au](http://www.flex-tools.com.au)  
[www.flex-tools.co.nz](http://www.flex-tools.co.nz)

---

For all FLEX warranty and enquiries, please contact Australia 1300 000 346 or  
New Zealand 0508 000 346

513.822 / 08-2021