

FLEX

OPERATOR'S MANUAL

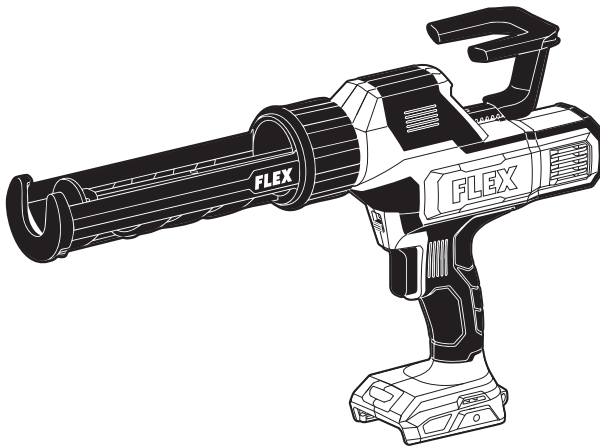

Model: FXA6211

24V CAULKING GUN

⚠ WARNING: To reduce the risk of injury, the user must read and understand the Owner's Manual before using this product. Save these instructions for future reference.



Please contact FLEX customer service in Australia 1300 000 346 or
New Zealand 0508 000 346 any time you have questions or warranty claims.

SAFETY SYMBOLS

The purpose of safety symbols is to attract your attention to possible dangers. The safety symbols and the explanations with them deserve your careful attention and understanding. The symbol warnings do not, by themselves, eliminate any danger. The instructions and warnings they give are no substitutes for proper accident prevention measures.

⚠ WARNING Be sure to read and understand all safety instructions in this Owner's Manual, including all safety alert symbols such as “**DANGER**,” “**WARNING**,” and “**CAUTION**” before using this tool. Failure to follow all instructions listed below may result in electric shock, fire, and/or serious personal injury.

The definitions below describe the level of severity for each signal word. Please read the manual and pay attention to these symbols.



This is the safety alert symbol. It is used to alert you to potential personal injury hazards. Obey all safety messages that follow this symbol to avoid possible injury or death.



DANGER indicates a hazardous situation which, if not avoided, will result in death or serious injury.



WARNING indicates a hazardous situation which, if not avoided, could result in death or serious injury.



CAUTION, used with the safety alert symbol, indicates a hazardous situation which, if not avoided, will result in minor or moderate injury.

GENERAL POWER TOOL SAFETY WARNINGS



WARNING Read all safety warnings, instructions, illustrations and specifications provided with this power tool. Failure to follow all instructions listed below may result in electric shock, fire and/or serious injury.

SAVE ALL WARNINGS AND INSTRUCTIONS FOR FUTURE REFERENCE.

The term “power tool” in the warnings refers to your mains-operated (corded) power tool or battery-operated (cordless) power tool.

Work area safety

Keep work area clean and well lit. Cluttered or dark areas invite accidents.

Do not operate power tools in explosive atmospheres, such as in the presence of flammable liquids, gases or dust. Power tools create sparks which may ignite the dust or fumes.

Keep children and bystanders away while operating a power tool. Distractions can cause you to lose control.

Electrical safety

Power tool plugs must match the outlet. Never modify the plug in any way. Do not use any adapter plugs with earthed (grounded) power tools. Unmodified plugs and matching outlets will reduce risk of electric shock.

Avoid body contact with earthed or grounded surfaces, such as pipes, radiators, ranges and refrigerators. There is an increased risk of electric shock if your body is earthed or grounded.

Do not expose power tools to rain or wet conditions. Water entering a power tool will increase the risk of electric shock.

Do not abuse the cord. Never use the cord for carrying, pulling or unplugging the power tool. Keep cord away from heat, oil, sharp edges or moving parts. Damaged or entangled cords increase the risk of electric shock.

When operating a power tool outdoors, use an extension cord suitable for outdoor use. Use of a cord suitable for outdoor use reduces the risk of electric shock.

If operating a power tool in a damp location is unavoidable, use a ground fault circuit interrupter (GFCI) protected supply. Use of a GFCI reduces the risk of electric shock.

Personal safety

Stay alert, watch what you are doing and use common sense when operating a power tool. Do not use a power tool while you are tired or under the influence of drugs, alcohol or medication. A moment of inattention while operating power tools may result in serious personal injury.

Use personal protective equipment. Always wear eye protection. Protective equipment such as a dust mask, non-skid safety shoes, hard hat or hearing protection used for appropriate conditions will reduce personal injuries.

Prevent unintentional starting. Ensure the switch is in the off-position before connecting to power source and/or battery pack, picking up or carrying the tool. Carrying power tools with your finger on the switch or energising power tools that have the switch on invites accidents.

Remove any adjusting key or wrench before turning the power tool on. A wrench or a key left attached to a rotating part of the power tool may result in personal injury.

Do not overreach. Keep proper footing and balance at all times. This enables better control of the power tool in unexpected situations.

Dress properly. Do not wear loose clothing or jewellery. Keep your hair, and clothing away from moving parts. Loose clothes, jewellery or long hair can be caught in moving parts.

If devices are provided for the connection of dust extraction and collection facilities, ensure these are connected and properly used. Use of dust collection can reduce dust-related hazards.

Do not let familiarity gained from frequent use of tools allow you to become complacent and ignore tool safety principles. A careless action can cause severe injury within a fraction of a second.

Power tool use and care

Do not force the power tool. Use the correct power tool for your application. The correct power tool will do the job better and safer at the rate for which it was designed.

Do not use the power tool if the switch does not turn it on and off. Any power tool that cannot be controlled with the switch is dangerous and must be repaired.

Disconnect the plug from the power source and/or remove the battery pack, if detachable, from the power tool before making any adjustments, changing accessories, or storing power tools. Such preventive safety measures reduce the risk of starting the power tool accidentally.

Store idle power tools out of the reach of children and do not allow persons unfamiliar with the power tool or these instructions to operate the power tool. Power tools are dangerous in the hands of untrained users.

Maintain power tools and accessories. Check for misalignment or binding of moving parts, breakage of parts and any other condition that may affect the power tool's operation. If damaged, have the power tool repaired before use. Many accidents are caused by poorly maintained power tools.

Keep cutting tools sharp and clean. Properly maintained cutting tools with sharp cutting edges are less likely to bind and are easier to control.

Use the power tool, accessories and tool bits etc. in accordance with these instructions, taking into account the working conditions and the work to be performed. Use of the power tool for operations different from those intended could result in a hazardous situation.

Keep handles and grasping surfaces dry, clean and free from oil and grease. Slippery handles and grasping surfaces do not allow for safe handling and control of the tool in unexpected situations.

Battery tool use and care

Recharge only with the charger specified by the manufacturer. A charger that is suitable for one type of battery pack may create a risk of fire when used with another battery pack.

Use power tools only with specifically designated battery packs. Use of any other battery packs may create a risk of injury and fire.

When battery pack is not in use, keep it away from other metal objects, like paper clips, coins, keys, nails, screws or other small metal objects, that can make a connection from one terminal to another. Shorting the battery terminals together may cause burns or a fire.

Under abusive conditions, liquid may be ejected from the battery; avoid contact. If contact accidentally occurs, flush with water. If liquid contacts eyes, additionally seek medical help. Liquid ejected from the battery may cause irritation or burns.

Do not use a battery pack or tool that is damaged or modified. Damaged or modified batteries may exhibit unpredictable behavior resulting in fire, explosion or risk of injury.

Do not expose a battery pack or tool to fire or excessive temperature. Exposure to fire or temperature above 130 °C may cause explosion.

Follow all charging instructions and do not charge the battery pack or tool outside the temperature range specified in the instructions. Charging improperly or at temperatures outside the specified range may damage the battery and increase the risk of fire.

Service

Have your power tool serviced by a qualified repair person using only identical replacement parts. This will ensure that the safety of the power tool is maintained.

Never service damaged battery packs. Service of battery packs should only be performed by the manufacturer or authorised service providers.

SAFETY WARNINGS FOR CAULKING GUN

Keep hands out of the plunger and plunger rod area of the caulking gun. Fingers can be crushed between the tube holder and the plunger.

When operating the caulking gun overhead, do not have plunger rod in the path of your eyes or head. Plunger rod may slip back in direction of user, if the plunger rod release button is pressed accidentally. Always wear eye protection when using the caulking gun.









When operating the caulk gun overhead, do not position your head and eyes directly below the nozzle. Caulk/adhesive may drip into eyes causing personal injury.



Always work in properly ventilated area and wear appropriate respiratory protection if necessary. Fumes from some caulks and adhesives can be noxious.

Lock trigger in the OFF position when not in use to avoid inadvertent release of material.

SYMBOLS

IMPORTANT: Some of the following symbols may be used on your tool. Please study them and learn their meaning. Proper interpretation of these symbols will allow you to operate the tool better and safer.

Symbol	Name	Designation/Explanation
V	Volts	Voltage
A	Amperes	Current
Hz	Hertz	Frequency (cycles per second)
W	Watt	Power
kg	Kilograms	Weight
min	Minutes	Time
s	Seconds	Time
Wh	Watt-hours	Battery capacity
Ah	Ampere-hours	Battery capacity
∅	Diameter	Size of drill bits, grinding wheels, etc.
n_0	No load speed	Rotational speed, at no load
n	Rated speed	Maximum attainable speed
.../min	Revolutions or reciprocations per minute (rpm)	Revolutions, strokes, surface speed, orbits, etc. per minute
O	Off position	Zero speed, zero torque...
1,2,3,... I,II,III,	Selector settings	Speed, torque, or position settings. Higher number means greater speed
	Infinitely variable selector with off	Speed is increasing from 0 setting
	Arrow	Action in the direction of arrow
	Alternating current (AC)	Type or a characteristic of current
	Direct current (DC)	Type or a characteristic of current
	Alternating or direct current (AC / DC)	Type or a characteristic of current
	Class II tool	Designates Double Insulated Construction tools.
	Read the instructions	Alerts user to read manual
	Wear eye protection symbol	Alerts user to wear eye protection

Symbol	Name	Designation/Explanation
 	WEEE	Waste electrical products should not be disposed of with household waste. Take to an authorised recycler.
	Regulatory compliance mark	This product complies with applicable Australian standards.

FUNCTIONAL DESCRIPTIONS AND SPECIFICATIONS

CAULKING GUN

Fig. 1

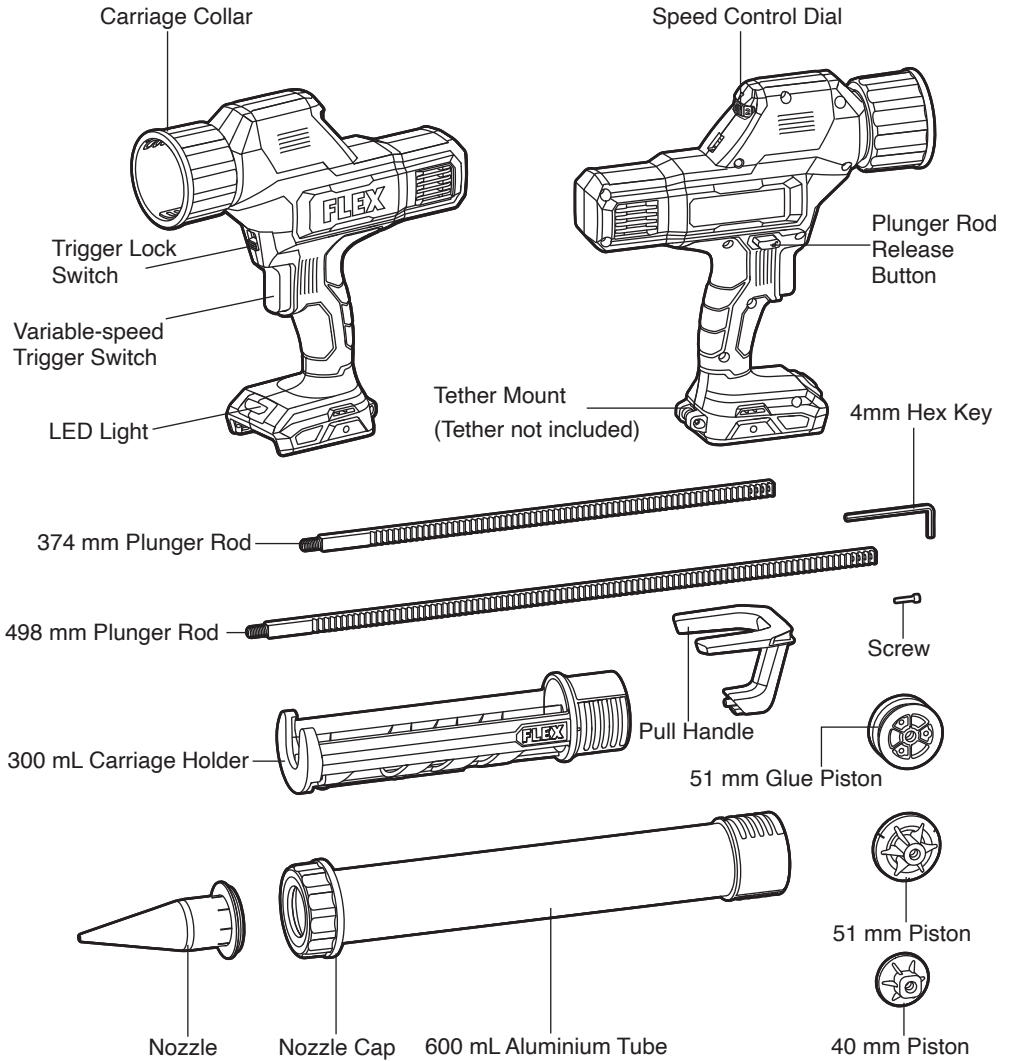

Model No.	FXA6211
Rated Voltage	24V d. c.
Feed Speed	0.5 mm/s – 14 mm/s
Recommended ambient operating temperature	0 – 40 °C
Recommended storage temperature	< 50 °C

Intended Use

The tool is intended for sealing up gaps and cracks.

ASSEMBLY

⚠ WARNING Detach the battery pack from the tool before performing any assembly or adjustments, or changing accessories. Such preventive safety measures reduce the risk of starting the tool accidentally.

TO ATTACH/DETACH BATTERY PACK (FIG. 2)

To attach the battery pack:

Align the raised rib on the battery pack with the grooves in the tool, and then slide the battery pack onto the tool.

NOTICE When placing the battery pack onto the tool, be sure that the raised rib on the battery pack aligns with the groove inside the tool and that the latches snap into place properly. Improper attachment of the battery pack can cause damage to internal components.

To detach the battery pack:

Depress battery-release button located on the front of the battery pack to release the battery pack. Pull the battery pack out and remove it from the tool.

Fig. 2

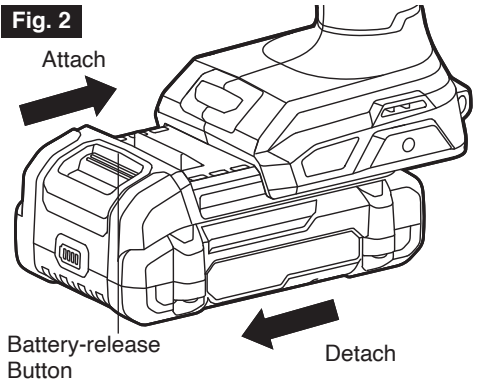

⚠ WARNING Do not attempt to modify this tool or create accessories not recommended for use with this tool. Any such alteration or modification is misuse and could result in a hazardous condition leading to possible serious injury.

TO ATTACH/REMOVE PLUNGER ROD AND PULL HANDLE

Plunger rod (Fig. 3a)

To attach the rod, depress the plunger rod release button and insert the rod from the front of the tool, then push it through the tool.

NOTE: The teeth on the rod must point down.

To remove the rod, depress the plunger rod release button, pull the plunger rod towards the front of the tool and remove it.

Two (2) types of plunger rods are available. Use appropriate plunger rod based on the carriage holder or tube type.

Fig. 3a

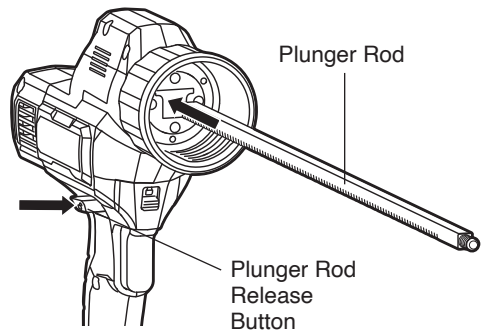

Plunger rod	Suitable carriage holder
374 mm Plunger Rod	300 mL Carriage Holder
498 mm Plunger Rod	600 mL Aluminium Tube

PULL HANDLE (FIG. 3b)

To attach the handle, insert the rear end of the plunger rod into the handle as shown, then insert the screw and securely tighten the screw with the included hex key.

To remove the handle, Use the included hex key to loosen the screw that attaches the handle to the plunger rod, remove the handle and the screw.

Fig. 3b

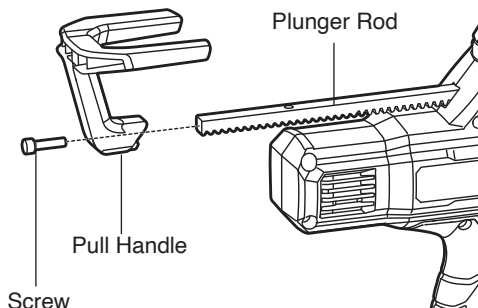

⚠ WARNING Make sure that the pull handle is properly secured to the plunger rod with the screw. Do not use damaged pull handle and screws. Before use, always check for damages, cracks, or deformities, and make sure that the screw is tightened.

TO ATTACH/REMOVE PISTON (FIG. 4)

To attach the piston, screw onto the front of the plunger rod in clockwise direction.

To remove the piston, unscrew it from the plunger rod in counterclockwise direction.

Three (3) types of pistons, suitable for different holders are included. Choose appropriate piston based on the type of carriage holder or tube. An improper piston may cause leakage or tool breakage.

Piston	Suitable carriage holder
40 mm Piston	300 mL Carriage Holder
51 mm Piston	600 mL Aluminium Tube (For Sausage Packs)
51 mm Bulk Glue Piston	600 mL Aluminium Tube (For Bulk Glue)

Fig. 4

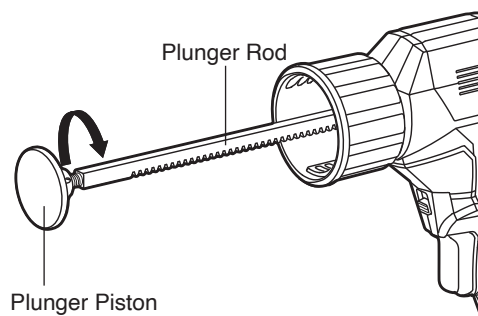

TO ATTACH/REMOVE CARRIAGE HOLDER OR TUBE (FIG. 5a – 5c)

NOTE: Carriage holder and tube are installed (or removed) in the same way. Fig. 5a and 5b show the carriage holder as an example.

To install the carriage holder, align the raised ribs on the carriage holder with the grooves in the carriage collar, and then insert the carriage holder into the collar.

Hold the carriage holder with one hand and the carriage collar with the other hand. Rotate the carriage holder in clockwise direction to engage the raised ribs into the grooves to lock the carriage holder.

The carriage holder or tube can be rotated 360° to use it at various angles. Rotate the carriage collar to adjust the carriage holder to the desired angle (Fig. 5c).

To remove the carriage holder, hold it with one hand and the carriage collar with the other hand. Rotate the carriage holder in counterclockwise direction to remove it.

NOTICE Always use appropriate plunger rod and piston in accordance with the carriage holder type.

Fig. 5a

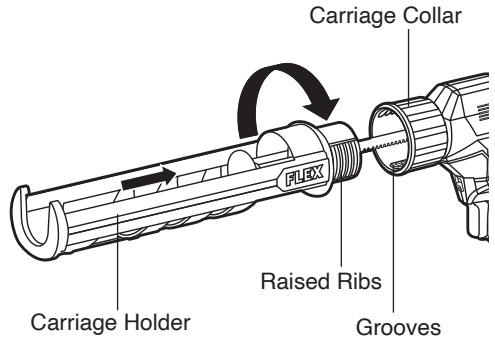

Fig. 5b

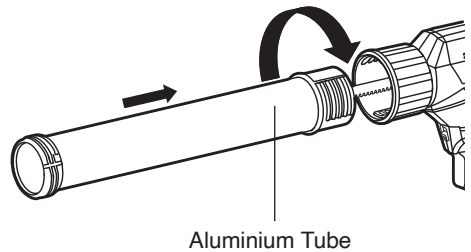
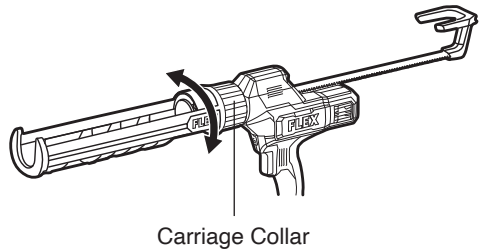

Fig. 5c



TO INSERT THE CAULKING MATERIAL

⚠ WARNING Keep plunger rod, carriage holder, or tube clean of all caulking material. Retracting a plunger rod that is covered with dried caulking material may damage the internal parts of the tool and cause misalignment of tube.

CAULKING TUBE (FIG. 6a - 6b)

- Remove battery pack.
- Ensure that the proper plunger rod, piston and carriage holder are installed properly.
- Lock the trigger switch.
- Cut off the tip of the caulking tube nozzle at the desired angle.

NOTE: The smaller the nozzle opening, the more force is required to push the caulking material.

- Puncture the inner seal of the caulking tube or adhesive material using the needle located on the underside of the carriage holder.
- Depress the plunger rod release button and pull the pull handle back to allow the caulking tube to fit inside the carriage holder.
- Insert the flat end of the caulking tube into the carriage holder then lower the nozzle. Make sure the tube is fully seated at both ends.
- Rotate the carriage holder to desired angle.
- To remove the caulking tube, lock the trigger switch. Depress the plunger rod release button and pull the pull handle back. Lift the tube up and remove it.

NOTE: If the caulking tube is not installed and the plunger rod is pushed to the front position, pressing the trigger switch will not start the tool.

Fig. 6a

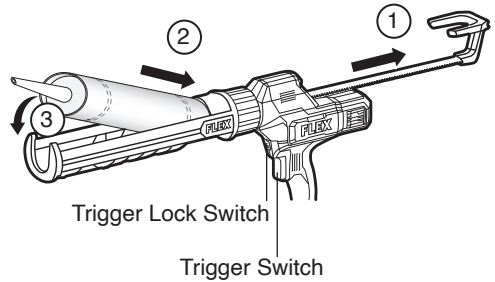
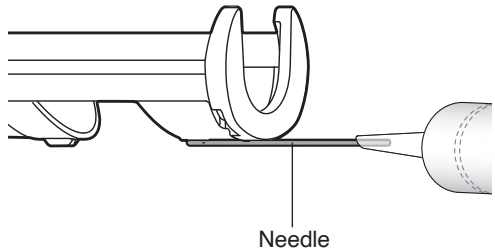

Fig. 6b



SAUSAGE PACK (FIG. 6c – 6d)

- Remove battery pack.
- Unscrew and remove the nozzle cap and the nozzle from the aluminium tube.
- Ensure that the proper plunger rod, piston, and aluminium tube are installed properly.
- Depress the plunger rod release button and pull the pull handle back to allow the sausage pack to fit inside the aluminium tube.
- Insert the sausage pack into the aluminium tube and cut casing (closest end to the nozzle).
- Insert the nozzle with nozzle tip facing away from the tool, then screw the nozzle cap onto the aluminium tube.
- Trim the tip of the nozzle at the desired angle and size.
- Push the pull handle forward until the piston is against the sausage pack.

NOTE: Caulking material left in the aluminium tube may dry if left unattended. Follow caulking material manufacturer's recommendations when using caulking material.

BULK GLUE (FIG. 6e)

- Remove battery pack.
- Unscrew and remove the nozzle cap and the nozzle from the aluminium tube.
- Ensure that the proper plunger rod, 51 mm bulk glue piston, and aluminium tube are installed properly.
- Depress the plunger rod release button and push the pull handle forward.
- Submerge the end of the aluminium tube into the bulk glue container. While pressing the plunger rod release button, pull the pull handle back to suck in the bulk glue.
- Wipe off the bulk glue on the outside of the aluminium tube.
- Insert the nozzle with nozzle tip facing away from the tool, then screw the nozzle cap onto the aluminium tube.

Fig. 6c

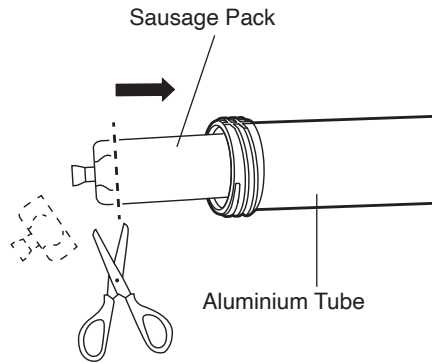

Fig. 6d

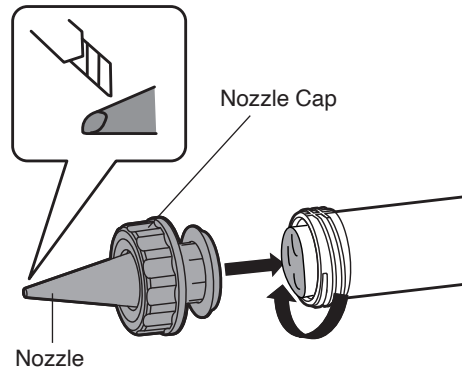
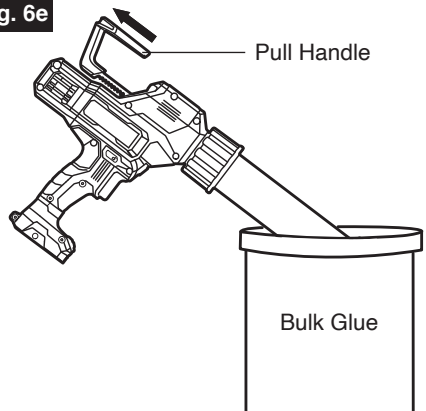

Fig. 6e



OPERATING INSTRUCTIONS

⚠ WARNING To reduce the risk of fire, personal injury, and product damage due to a short circuit, never immerse your charger or battery pack in fluid or allow a fluid to flow inside them. Corrosive or conductive fluids, such as seawater, certain industrial chemicals, and bleach or bleach-containing products, etc. can cause a short circuit.

⚠ WARNING If any parts are damaged or missing, do not operate this product until the parts are replaced. Use of this product with damaged or missing parts

could result in serious personal injury.

⚠ WARNING To prevent accidental starting that could cause serious personal injury, always remove the battery pack from the tool when assembling or adjusting parts.

⚠ WARNING Always wear eye protection. Eye protection does not fit all operators in the same way. Make sure the chosen eye protection has side shields or provides protection from flying debris both from the front and sides.

This caulking gun must be used only with the FLEX 24V series battery packs and chargers.

NOTICE: Please refer to the battery pack and charger manuals for detailed operating information.

VARIABLE-SPEED TRIGGER SWITCH (FIG. 7)

Your tool is equipped with a trigger lock switch to prevent the caulking material from spilling out due to accidental activation of the trigger switch.

To lock the trigger switch, push trigger lock switch down. The tool will not operate with the trigger lock switch in the locked position.

To unlock the trigger switch, push the trigger lock switch up.

To turn the tool on, press the variable-speed trigger switch.

The variable trigger switch delivers higher plunger speed with increased trigger pressure and lower speed with decreased trigger pressure.

To turn the tool off, release the variable-speed trigger switch.

NOTE: The trigger pressure, selected maximum plunger speed, material type, temperature and nozzle diameter will all affect the flow rate.

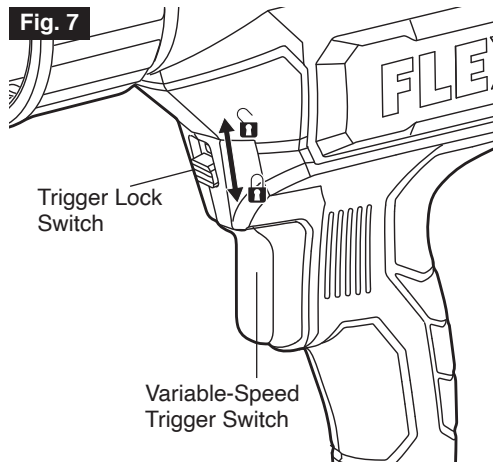

LED LIGHT (FIG. 8)

The LED light will turn on when the trigger switch is depressed. This provides additional illumination of the work surface.

The LED light will turn off within approximately 10 seconds after the trigger switch is released.

Fig. 8

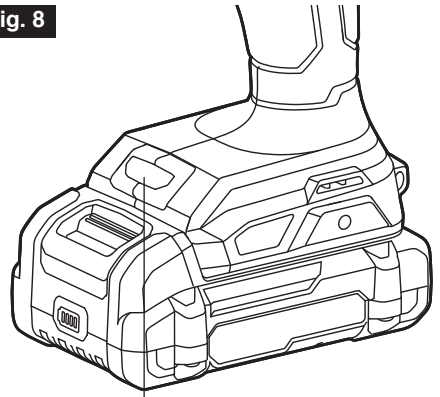

LED Light

SPEED CONTROL DIAL (FIG. 9)

The speed control dial establishes the maximum plunger speed.

Turn the dial to any position between “1” for the lowest maximum speed and “6” for the highest maximum speed.

NOTE: Operating the caulking gun at high speeds may damage the dispensing tube or pack for some caulking materials. For best results, gradually increase speed settings.

Fig. 9

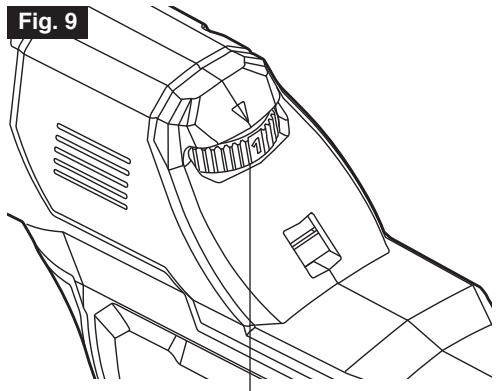

Speed Control Dial

ANTI-DRIP

This caulking gun features an automatic retraction system that prevents caulk from leaking during shutdown. When the trigger is released, the plunger rod immediately retracts, releasing pressure on the piston to prevent dripping.

USING THE CAULKING GUN

- Prepare the surface to be caulked by removing any dust, dirt, or remnants of old caulking. Make sure the area to be caulked is clean and dry.
 - Set the speed of the caulking gun to match your application needs, using just enough caulk to do the job. Experiment in an out-of-the-way area to find the best speed to deliver the caulk bead you want.
 - Unlock the trigger switch.
 - Hold the gun at a slight angle. If filling a crack, insert the nozzle into the crack, if possible; otherwise, run the caulking gun along the surface.
 - Squeeze the trigger switch to allow the caulking material to extrude from the nozzle.
- **NOTE:** If the bead of caulk is too narrow, re-cut the nozzle tip to provide a larger opening. However, it is better to apply a thin bead of caulk and add a little more if necessary than to apply too much and attempt to remove the excess.
 - Carefully move the caulking gun at an even pace along the gap to be filled as you continue to depress the trigger switch. Make sure the caulking material comes in full contact with both application surfaces. If necessary, use your finger to gently press the caulking material into a corner or crack.
 - After finishing, release the trigger switch.

NOTE: As soon as the caulking tube is empty, the piston of the plunger will retract 2 mm from the frontmost position, and then the tool will shut off automatically. Pull the pull handle back and replace the caulking tube as necessary.

- Use a damp towel or rag to clean off any excess caulking material.

MAINTENANCE

SERVICE

⚠ WARNING Preventive maintenance performed by unauthorised personnel may result in misplacing of internal wires and components which could cause a serious hazard. We recommend that all tool service be performed by a FLEX Factory Service Centre or Authorised FLEX Service Station.

GENERAL MAINTENANCE

⚠ WARNING When servicing, use only identical replacement parts. Use of any other parts could create a hazard or cause product damage. Periodically inspect the entire product for damaged, missing, or loose parts such as screws, nuts, bolts, caps, etc. Tighten securely all fasteners and caps and do not operate this product until all missing or damaged parts are replaced. Please contact customer service or an authorised service centre for assistance.

⚠ WARNING To avoid serious personal injury, always remove the battery pack from the charger/tool when cleaning or performing any maintenance.

⚠ WARNING Follow instructions included with caulking material to clean material from nozzle, plunger rod, pistons, carriage holders or tubes.

⚠ WARNING Certain cleaning agents and solvents damage plastic parts. Some of these are: gasoline, carbon tetrachloride, chlorinated cleaning solvents, ammonia and household detergents that contain ammonia.

STORAGE

Store the tool indoors in a place that is inaccessible to children. Keep away from corrosive agents.

WARRANTY STATEMENT

Chervon Australia Pty Ltd (ABN 36 165 077 501) of Unit 14,5 Kelletts Road, Rowville, Victoria, 3178, and Chervon New Zealand Subsidiary Ltd (NZBN 9429049277616) (**Chervon**) provides the following warranty (**Warranty**) to original domestic purchasers in Australia and New Zealand as applicable (**Customers**) of its FLEX 24V Tools, FLEX 24V Batteries and Chargers and FLEX STACK PACK™ Storage System (collectively **Products**).

The benefits of this Warranty are in addition to any rights and remedies imposed by Australian State and Federal or New Zealand legislation that cannot be excluded. Nothing in this Warranty is to be interpreted as excluding, restricting or modifying any legislation relevant to the supply of goods and services in Australia or New Zealand, as applicable, which cannot be excluded, restricted or modified.

In Australia, if the claimant is a “consumer” under the *Australian Consumer Law*, Chervon confirms the following:

Our goods come with guarantees that cannot be excluded under the Australian Consumer Law. You are entitled to a replacement or refund for a major failure and compensation for any other reasonably foreseeable loss or damage. You are also entitled to have the goods repaired or replaced if the goods fail to be of acceptable quality and the failure does not amount to a major failure.

WARRANTY

Chervon warrants that, subject to the terms of this Warranty and the exclusions and limitations contained herein, the Products will be free from defects in materials and workmanship for the following period, as applicable, calculated from the date of purchase of the Product (**Warranty Period**):

- If the Customer registers its purchase of the Product online at www.flex-tools.com.au in Australia or www.flex-tools.co.nz in New Zealand within 30 days of the date of its purchase (**Registration**), the Warranty Period for the following Products is as follows
 - FLEX 24V Tools: 5 years;
 - FLEX 24V Batteries and Chargers: 5 years;
 - FLEX STACK PACK™ Storage System: 1 year;
 - FLEX Accessories & Consumables: 90 Days
- If the Customer fails to complete Registration as outlined above, the Warranty Period for the following Products is as follows:
 - FLEX 24V Tools: 3 years;
 - FLEX 24V Batteries and Chargers: 3 years;
 - FLEX STACK PACK™ Storage System: 1 year;
 - FLEX Accessories & Consumables: 90 Days

For further clarification and avoidance of doubt please refer to the FLEX product warranty table included below.

If, before the end of the Warranty Period, a defect appears in the manufacture or assembly of a Product, and Chervon finds the Product to be defective in materials or workmanship, it will, in its sole discretion, either:

- replace or repair the Product or the defective part of the Product free of charge; or
- cause the Product or the defective part of the Product to be replaced or repaired free of charge.

Chervon reserves the right to replace a defective Product or part of a Product with parts and components of similar quality, grade and composition where an identical part or component is not available. Where the product is repaired, Chervon may use refurbished parts.

WARRANTY CLAIMS

1. If a defect covered by Warranty appears, you must first contact Chervon:
 - (a) by telephone on 1300 000 346 (AU); or 0508 000 346 (NZ); or
 - (b) by email at support@flex-tools.com.au.
2. Any Warranty claim must be accompanied by:
 - (a) proof of purchase;
 - (b) full details of the alleged defect;
 - (c) photo evidence of the alleged defect; and
 - (d) any other relevant documents.
3. You must allow Chervon or its authorised agent to inspect and test the Product. If that inspection and test finds no defect in the Product, you must pay Chervon's usual service and testing costs.
4. Unless otherwise agreed in writing by Chervon, you must pay the cost of transporting the Product to and from Chervon or Chervon's authorised agent and any related insurance cost. Any handling and transportation costs (and other expenses incurred in claiming this warranty) are not covered by this warranty and will not be borne by Chervon.
5. The replacement product or part, or repaired product will be made available for your collection at an address nominated by Chervon.
6. Customers are responsible for the care and cleaning of their product prior to sending it to back to Chervon or its nominated authorised repair agents. Any product being sent for repair must be cleaned. It is an Occupational/Work Health and Safety risk for our staff or authorised repairers to inspect, repair or service a product that has come into contact with a hazardous substance.
7. If Chervon or its authorised repair agent is to inspect, repair or service a product that has come into contact with a hazardous substance such as asbestos, silica dust or other hazardous substance then we may not be able to inspect, service or repair the product. If this is the case, Chervon reserves the right to refuse repair under these circumstances and will inform the customer and the product will be returned at the customer's expense.

EXCLUSIONS

The Warranty does not apply if:

- (a) the Product is not supplied in its final shape and form by Chervon or an authorised FLEX Dealer, which can be confirmed on the website store locator (for avoidance of doubt, third party online stores such as eBay, Gumtree, Amazon, etc. are excluded);
- (b) the Product is altered, modified or repaired by a party other than Chervon or its agent;
- (c) the Product is used other than for its designed purpose;
- (d) the Product is used for rental purposes
- (e) the Product is used or installed other than in accordance with Chervon's instructions;
- (f) the Product has not been maintained or protected in accordance with Chervon's instructions;
- (g) the Product has been subject to abnormal conditions;
- (h) the product suffers normal deterioration of the exterior finish, including but not limited to scratches, dents, paint chips, or to any corrosion or discolouring by heat, abrasive and chemical cleaners.
- (i) the Product is involved in an accident;
- (j) Chervon cannot find any defect in the Product after testing, inspection and assessment;
- (k) the alleged defect is due to abuse, misuse, neglect (including failure to clean) or accident;

- (l) the alleged defect is due to a failure to properly maintain or use the Product;
- (m) the alleged defect in the Product is within acceptable industry standards or tolerances; or
- (n) the alleged defect is due to a request to customise the Product.
- (o) the alleged defect is due to normal wear and tear, misuse or abuse (including overloading of the product beyond capacity and exposure to water or rain)
- (p) The alleged defect has been used or caused due to continuous industrial use

The Warranty does not extend to:

- (a) damage or defects caused by normal wear and tear;
- (b) the Products being damaged by you or a third party;
- (c) accidental or wilful damage, or misuse; or
- (d) theft or vandalism.

This Warranty does not extend to other accessories or attachments.

LIMITATIONS

Chervon makes no express warranties or representations other than as set out in this document. Chervon will not be liable to you or any other person in connection with this Warranty for any:

- (a) consequential or indirect loss, damage or costs incurred by you or any other person; or
- (b) damage to property, loss of turnover, loss of profits, loss of business or loss of good will.

CONTACT

For Warranty Service or to make a claim please contact Chervon on the details below between the hours of Monday to Friday 9:00am to 5:00pm EST/NZST (as applicable)

Chervon Australia Pty Ltd

Unit 14, 5 Kelletts Rd, Rowville, VIC. 3178.

Ph Australia; 1300 000 346. Email: support@flex-tools.com.au

Chervon New Zealand Subsidiary Ltd

4th Floor, Smith & Caughey Building, 253 Queen St, Auckland, 1141.

Ph New Zealand; 0508 000 346. Email: support@flex-tools.com.au

WARRANTY TYPE	LIMITED STANDARD WARRANTY PERIOD	LIMITED EXTENDED WARRANTY PERIOD
CONDITIONS	Without Registration / OR Registration after 30 days from date of purchase	Registration within 30 days from date of purchase
FLEX 24V Power Tools	3 Years	5 Years
FLEX 24V Chargers	3 Years	5 Years
FLEX 24V Lithium-ion Batteries	3 Years	5 Years
FLEX Accessories & Consumables	90 Days	
FLEX STACK PACK™ Storage System	1 Year	

*Original purchaser must register the product(s) within 30 days of purchase and retain their receipt as proof of purchase. This warranty applies only to the original purchaser from an authorised FLEX dealer and may not be transferred. If original purchaser does not register their product within 30 days, the warranty will apply for the duration set out in table above in column 'LIMITED STANDARD WARRANTY PERIOD'. For avoidance of doubt please refer to warranty table above and full warranty details in this manual or on our website at www.flex-tools.com.au

